

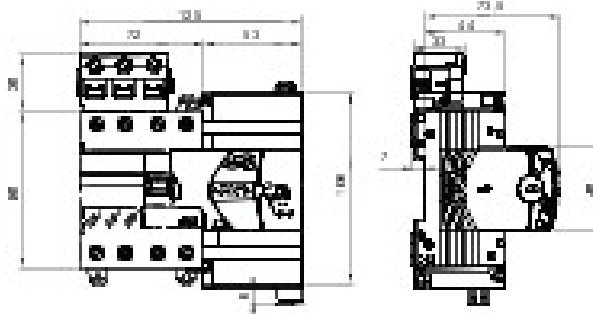

Description Automatic reclosing device
 Code ReStart Rm PRO 4P
 Suitable for RCBO's MDC - 1P+N/2P/4P - 100 and 300 mA
 Rated voltage AC 230 V
 Rated current 6 - 10 - 16 - 20 -25 - 32 A
 No. modules 3
 Standard EN 50557
 Rated frequency (Hz) 50Hz

Distribution system	TT - TN-S	Rated non-operating resistance between live parts and earth (Rdo)	2,5 kΩ
Insulation voltage	500 V	Rated operating resistance between live parts and earth (Rd)	5 kΩ
Rated impulse withstand voltage	4 kV	Maximum operating frequency	30 oper./h
Overvoltage category	III	Mechanical endurance	4000
Dielectric strength test voltage between pole and earth	2500 Vac for 1 minute	Type of residual current protection	AC - A - A[S]
Rated residual operating current	300 mA	Operating temperature	-25 +60 °C
Stocking temperature	-40 +70 °C	Type of contacts	Photomos (privo di potenziale)
Voltage operating	5-230 V ac/dc	Current operating	0.6mA (min)-100mA cos=1 (max)
Frequenza di funzionamento	50 Hz	Use category	AC12
Operating modes	NO/NC/NO with handle position signalling function	Rated tightening torque	0,4 Nm
Terminal section	≤ 2,5 mm ²	Automatic reclosure for untimely tripping	Yes
Earth failure test	Yes	Continuous system monitoring	Yes
Complete with	Un dispositivo tra: Modulo Wi-Fi GW90945 - Contatto ausiliario GWD0951 - Modulo BUS RS485 GW90992	Electrocod	1413

DIMENSIONAL



STANDARDS/APPROVALS



GEWISS S.p.A. Via A. Volta, 1
 24069 Cenate Sotto - Bergamo - Italy
 tel. +39 035 94 61 11 fax +39 035 94 69 09

www.gewiss.com
 sat@gewiss.com
 Last update 22/10/2019

Data, measures, designs and pictures are shown only as informativ purposes, and could be changed without previous notice