

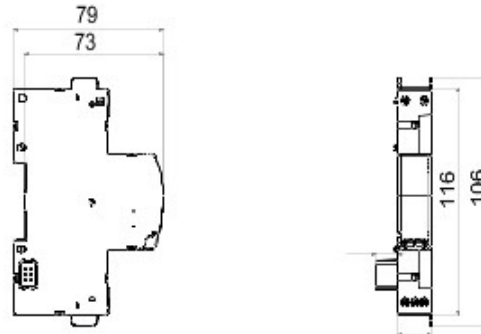

Wi-Fi communication interface module (GW90954) must be coupled on the right side of ReStart Autotest PRO 4P. Thanks to Wi-Fi ReStart APP, you can monitor the the system status in real time and everywhere. The proper functioning of the residual current device can be tested at all times, operating self-diagnosis remotely with your APP: you have the possibility to have details about date, time and outcomes of all the Autotest operations.

Description	Interface module Wi-Fi	Code	90 ReStart range
No. of modules EN 50022	1	Suitable for	ReStart Autotest PRO 4P
Rated frequency (Hz)	50	Rated voltage	230/240 V a.c.
Max power consumption	1,6 W	Operating temperature	-25 +60 °C
Rated impulse withstand voltage	4 kV	Rated tightening torque	0,4 Nm
Stocking temperature	-40 +70 °C	Rated insulation voltage (Ui)	500 V
Standard	EN 301489-1; EN 301489-17	Distribution system	TT - TN-S
Terminal section	2.5 mm ²	Minimum requirements of the operating system	Android 4.4 / iOS 9
Wi-Fi communication	2.4	Maximum Wi-Fi range	100m free space trasmission (towards router) - 80m free space trasmission (other directions)
Maximum measurable current	80 A	CT maximum cable section	25 Quadratmillimeter
Measure of electrical parameters	No		

DIMENSIONAL



STANDARDS/APPROVALS



GEWISS S.p.A. Via A. Volta, 1
24069 Cenate Sotto - Bergamo - Italy
tel. +39 035 94 61 11 fax +39 035 94 69 09

www.gewiss.com
sat@gewiss.com
Last update 14/11/2019

Data, measures, designs and pictures are shown only as informativ purposes, and could be changed without previous notice