

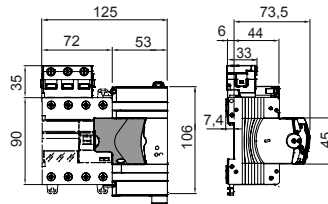

Description Automatic reclosing device
 Code ReStart Rm PRO 4P
 Suitable for RCBO's MDC - 1P+N/2P/4P - 100 and 300 mA
 Rated voltage AC 230 V
 Rated current 6 - 10 - 16 - 20 -25 - 32 A
 No. modules 3
 Standard EN 50557
 Rated frequency (Hz) 50Hz

| | | | |
|---|--|---|---------------------------------|
| Distribution system | TT - TN-S | Rated non-operating resistance between live parts and earth (Rdo) | 2,5 kΩ |
| Insulation voltage (Ui) | 500 V | Rated operating resistance between live parts and earth (Rd) | 5 kΩ |
| Rated impulse withstand voltage (Uimp) | 4 kV | Maximum operating frequency | 30 oper./h |
| Overvoltage category | III | Mechanical endurance | 4000 |
| Dielectric strength test voltage between pole and earth | 2500 Vac for 1 minute | Type of residual current protection | AC - A - A[S] |
| Rated residual operating current | 300 mA | Operating temperature | -25 +60 °C |
| Stocking temperature | -40°C ÷ +70°C | Type of contacts | Photomos (potential free) |
| Voltage operating | 5-230 V ac/dc | Current operating | 0.6mA (min)-100mA cosφ= 1 (max) |
| Operating frequency | 50 Hz | Use category | AC12 |
| Operating modes | NO/NC/NO with handle position signalling function | Rated tightening torque | 0,4 Nm |
| Terminal section | ≤ 2,5 mm² | Automatic reclosure for untimely tripping | Yes |
| Earth failure test | Yes | Continuous system monitoring | Yes |
| Completeable with | GWD0951 Auxiliary contact - GW90992 RS485 BUS Module | Electrocod | 1413 |

DIMENSIONAL



STANDARDS/APPROVALS

