

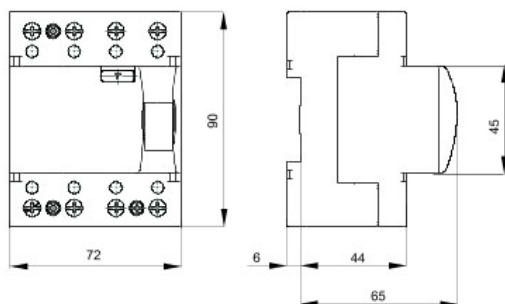

|   |                                  |
|---|----------------------------------|
| Description                               | RESIDUAL CURRENT CIRCUIT BREAKER |
| Code                                      | SD                               |
| No. of poles                              | 4P                               |
| No. modules                               | 4                                |
| Rated current                             | 125 A                            |
| Rated residual operating current          | 30 mA                            |
| Type                                      | AC                               |
| Rated voltage (EN/IEC 61008-1, 61008-2-1) | 400/415 V                        |

|                           |                                  |                                 |            |
|---------------------------|----------------------------------|---------------------------------|------------|
| Standard                  | IEC/EN 61008-1, IEC/EN 61008-2-1 | Rated frequency (Hz)            | 50Hz       |
| Insulation voltage        | 500 V                            | Rated impulse withstand voltage | 4 kV       |
| Overtoltage category      | III                              | Level of immunity (8/20 μs)     | 250 A      |
| Section rigid cable       | <50                              | Section flexible cable          | <50        |
| Rated tightening torque   | 3 Nm                             | Double connection               | No         |
| Operating temperature     | -25 +40 °C                       | Stocking temperature            | -40 +70 °C |
| Electrical endurance      | ≥ 10.000                         | Mechanical endurance            | ≥ 10.000   |
| Auxiliaries compatibility | Yes                              | ReStart compatibility           | No         |
| Assembly position         | Any                              |                                 |            |

### DIMENSIONAL



### WIRING DIAGRAM

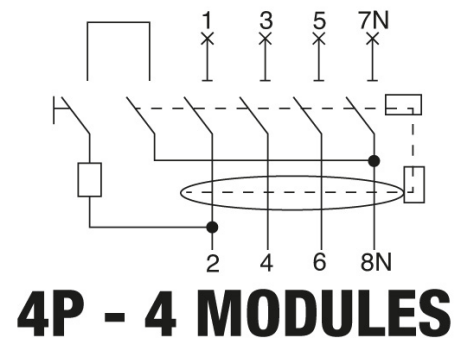

### STANDARDS/APPROVALS

