



Description MINIATURE CIRCUIT BREAKER

Code MT 250

No. of poles 1P

No. modules 1

Rated current 40 A

Curve C

Rated voltage 230-400 V

Standard	IEC EN 60898-1	Rated frequency (Hz)	50/60 Hz
Breaking capacity EN 60898 230V (Icn)	15000 A	Breaking capacity EN 60898 (Ics)	0.5 x Icn
Breaking capacity IEC/EN 60947-2 230V (Icu)	15 kA	Breaking capacity IEC/EN 60947-2 (Ics)	50% Icu
Insulation voltage (Ui)	500 V	Rated impulse withstand voltage (Uimp)	4 kV
Minimum operating voltage	12 V ac/dc	Maximum operating voltage	440 V AC / 220 V DC
Electrical endurance	10.000	Mechanical endurance	20.000
Section rigid cable	<=1x35 - <=2x16 - <=1x16+2x10 mm ²	Section flexible cable	<=1x35 - <=2x16 - <=1x16+2x10 mm ²
Rated tightening torque	2 Nm	Operating temperature	-25 +70 °C
Stocking temperature	-40°C + +70°C	Electrocod	1411

DIMENSIONAL

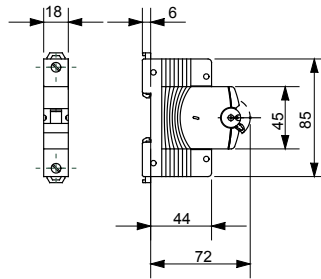

STANDARDS/APPROVALS



GEWISS S.p.A. Via A. Volta, 1
24069 Cenate Sotto - Bergamo - Italy
tel. +39 035 94 61 11 fax +39 035 94 69 09
Company subject to the management and
coordination of Polifin S.p.A.

www.gewiss.com
sat@gewiss.com
Last update 27/05/2026

Data, measures, designs and pictures are shown
only as informative purposes,
and could be changed without previous notice