

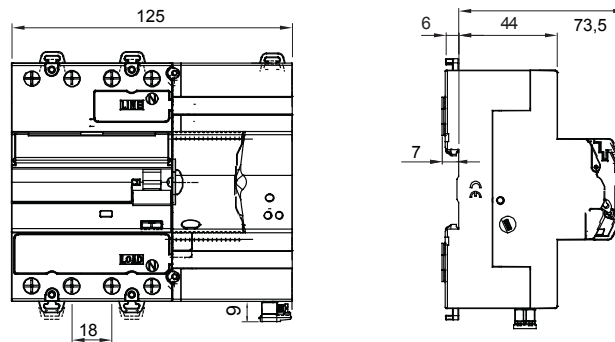

Description Automatic reclosing device  
 Code ReStart Autotest PRO 4P  
 Rated voltage AC 400 V  
 Rated current 63 A  
 No. modules 7  
 Standard IEC EN 63024, IEC EN 61008-1, IEC EN 61008-2-1  
 Rated frequency (Hz) 50 Hz  
 Distribution system TT - TN-S

|   |                                  |   |                        |
|---|----------------------------------|---|------------------------|
| Rated non-operating resistance between live parts and earth (Rdo) | 8 kΩ                             | Insulation voltage (Ui)                                 | 500 V                  |
| Rated operating resistance between live parts and earth (Rd)      | 16 kΩ                            | Rated impulse withstand voltage (Uimp)                  | 4 kV                   |
| Maximum operating frequency                                       | 30 oper./h                       | Overvoltage category                                    | III                    |
| Mechanical endurance  | 4000                             | Dielectric strength test voltage between pole and earth | 2500 V ac for 1 minute |
| Type of residual current protection                               | A[IR]                            | Rated residual operating current                        | 30 mA                  |
| Operating temperature   | -25 +60 °C                       | Stocking temperature                                    | -40°C ÷ +70°C          |
| Type of contacts  | Photomos (potential free)        | Voltage operating                                       | 5-230 V ac/dc          |
| Current operating   | 0.6 mA (min)-100 mA cosφ=1 (max) | Operating frequency                                     | 50 Hz                  |
| Use category  | AC12                             | Operating modes   | NO/NC/NC + pulse       |
| Rated tightening torque   | 0,4 Nm                           | Terminal section  | ≤ 2,5 mm²              |
| Automatic reclosure for untimely tripping                         | Yes                              | Earth failure test                                      | Yes                    |
| Continuous system monitoring                                      | Yes                              | Autotest (automatic RCCB protection test)               | Yes                    |
| Completeable with   | GW90992 RS485 BUS Module         | Number of poles   | 4P                     |
| Electrocod  | 1414                             |   |                        |

### DIMENSIONAL



### STANDARDS/APPROVALS

