

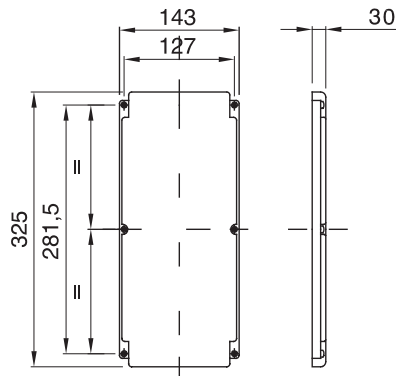

IP degree	IP66	Mechanical resistance	> IK10
For Modular bases	GW66696 - GW66697 - GW66698 - GW66781 - GW66782 - GW66783	For back boxes	GW66685
Glow Wire Test	850 °C	Suitable for	Heavy duty
Electrocod	2222	Impact resistance at -20 °C	20 J

DIMENSIONAL



TECHNICAL SYMBOLOGY

IP

IP66

IK

> IK10

GWT

850 °C

STANDARDS/APPROVALS

