

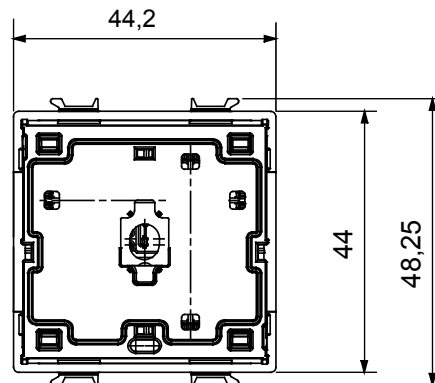

Flush-mounting axial auxiliary module with one command. An axial push-buttons on the front; this product can be used in combination with the auxiliary wired inputs of the following devices of the Chorusmart range: connected commands, connected 1- channel On/Off actuator, connected movement sensors, EVO commands, or as a wired command for a connected 2-channel ZigBee interface. The module with 1 auxiliary axial command can also be used to directly command small resistive or weakly inductive loads such as ringers and buzzers (max. 10VA);. The device must be completed with one of the front buttons key available.

Description	1-channel auxiliary axial command	Power supply	100 ÷ 240 V ac - 50/60 Hz
No. modules	2	No. input channels	-
Local control	Via front push button (to complete with button key)	Auxiliary input channel voltage	-
Stocking temperature	-25 ÷ +70 °C	N. of LED input channels	1
Working temperature	-5 ÷ +45 °C	LED input channels voltage	100 ÷ 240 V ac - 50/60 Hz
Relative humidity (non-condensative)	Max 93%	No. output channels	1
Front light signaling	Blue led	Output contacts	1 A (AC1)
Wiring terminals	With screw	240 V ac Incandescent-halogen lamps	-
Terminal tightening capacity stranded cables (mm <sup>2</sup> )	Max. 1,5	240 V ac LED lamps	-
Terminal tightening capacity solid cables (mm <sup>2</sup> )	Max. 1,5	Loads piloted from electronic transf. 240 V ac	-
Context	Dry indoor places	240 V Fluorescent lamps	-
IP degree	IP20 (with button key)	Load control	-
Standard	2014/35/EU (LVD), 2011/65/EU + 2015/863 (RoHS), EN 60669-1, EN IEC 63000		

### DIMENSIONAL

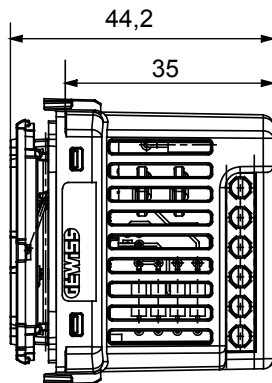

### TECHNICAL SYMBOLOGY

**IP**

IP20 (with button key)

### STANDARDS/APPROVALS

