

Seria STREET [03]

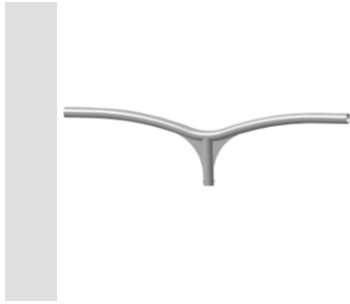

Double pole head bracket in hot galvanised steel tubing, 3 or 4mm thick, hot galvanised steel and painted with polyester powder. Supplied with three M8 stainless steel lockscrews for fixing on poles of 60mm diameter.

Opis	Podwójny wspornik na głowicę słupa	Seria	STREET [03]
Masa (kg)	11.5	Kolor	Szary grafitowy
Wymiar	Ø 60mm	Długość (mm)	1+1 m
Electrocod	240		

### DIMENSIONAL

### PHOTOMETRIC DISTRIBUTION

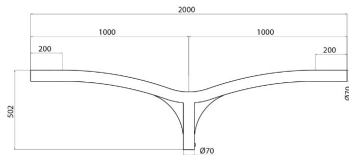

### TECHNICAL SYMBOLOGY

### STANDARDS/APPROVALS

