

STADIUM PRO 3 is a high power LED floodlight, with an LES (light emitted surface) high emission, suitable for lighting sports facilities for professional competitive competitions. The spotlight has a graphite grey finish with trivalent treatment for maximum resistance to oxidation and is equipped with an integrated “self-cleaning” thermal dissipation system. It consists of three modules, each with a venting and non-condensing valve, protected from accidental impacts. The rotation system between the bracket and the optical modules is truncated-conical in aluminium with an integrated goniometer within the bracket for easy orientation control and fixing by means of a grub-screw, which ensure the tightness over time of each individual module. The spotlight is available in 4,000K or 5,700K colour temperatures and CRI>70, CRI>80 or CRI>90 (TLCI>80) colour rendering. The range also includes 6 types of circular optics, from 8° to 40°, 1 symmetrical/Elliptical optic and 2 asymmetric optics. The T.I.R.Ex optical system developed by GEWISS, with high transparency PMMA HT lenses, permits total control over the light beam, allowing for wide flexibility in the design environment, with high qualitative and quantitative performance. The power supply box can be fixed on the edge-bracket, or remotely, it is immune to surges of up to 10KV both in RCCB and common mode, with a single cable. The range includes a DALI2 or DMX-RDM power supply, to allow maximum flexibility in the creation of even complex light sets.

Stadium Pro is for a professional use hence the photometric data are not disclosed. We invite you to take contact with our technical and commercial teams.

| GENERAL INFORMATION                     |   | OPTIC AND ILLUMINATING FEATURES     |  |
|---|---|-------------------------------------|--|
| Context                                 | Professional sport lighting                     | Optic                               | Circular 20°   |
| Luminaire                               | High power LED floodlight                       | Unified Glare Rating                | ULOR = 0%  |
| Application                             | Indoor / Outdoor                                | Lumen output (lm)                   | 125000   |
| Unique digital code (Datamatrix)        | Currently not present                           | Efficacy (lm/W)                     | 86   |
| Colour                                  | Graphite grey                                   | Colour temperature                  | 5700 K   |
| Type of light source                    | LED   | Colour Rendering Index              | CRI>90 TLCI>80                                       |
| System power                            | 1450 W  | Standard Deviation Colour Matching  | SDCM = 3   |
| LED Lifetime                            | L90B10(Tq25°C)=40.000h; L80B10 (Tq25°C)=75.000h | Photobiological Risk Class          | -  |
| Weight (kg)                             | 30  | Standard                            | EN60598-1; EN60598-2-5; IEC 62471; IEC 62778         |
| Warranty                                | 5 years   | ELETRICAL AND LIGHTING FEATURES     |  |
| Stocking temperature                    | -   | Supply voltage                      | See external supply unit                             |
| Operating temperature                   | -25 +50 °C                                      | Rated frequency (Hz)                | See external supply unit                             |
| MATERIALS                               |   | Driver                              | To be ordered separately                             |
| Body                                    | Die-cast aluminium                              | Driver failure rate                 | See external supply unit                             |
| Shield type                             | Flat tempered glass 4mm                         | Overvoltage protection              | See external supply unit                             |
| Optic                                   | T.I.R.Ex. Optical PMMA HT                       | Control System                      | See external supply unit                             |
| Gasket                                  | Anti-aging silicone                             | INSTALLATION AND MAINTENANCE        |  |
| Locking Hook                            | -   | Mounting and installation           | Lighting tower - Surface                             |
| External screw                          | Stainless steel                                 | Tilt                                | Rotation on bracket with integrated goniometer       |
| Colour                                  | Polyester powder coated                         | Wiring                              | Multipolar cable between floodlight and power supply |
| STANDARDS AND APPROVALS                 |   | Fixing                              | Bracket  |
| Classification                          | -   | Light source replaceability         | By professional                                      |
| Device with reduced surface temperature | -   | Controlgear replaceability          | By professional                                      |
| DIN 18032-3 certification               | Available                                       | Driver Box                          | External   |
| IPEA                                    | -   | Maximum surface exposed to the wind | 0,36 m²  |
| Insulation class                        | I   |                                     |  |
| IP degree                               | IP66  |                                     |  |
| Mechanical resistance                   | IK08  |                                     |  |
| Glow Wire Test                          | -   |                                     |  |

## DIMENSIONAL

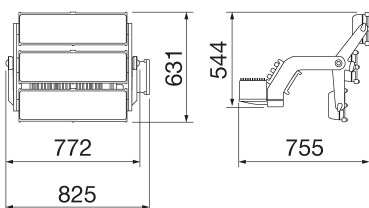

## PHOTOMETRIC DISTRIBUTION

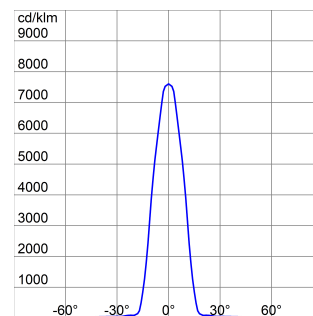

#### TECHNICAL SYMBOLOGY



**IP**  
IP66

**IK**  
IK08

**GWT**  
-

#### STANDARDS/APPROVALS

