

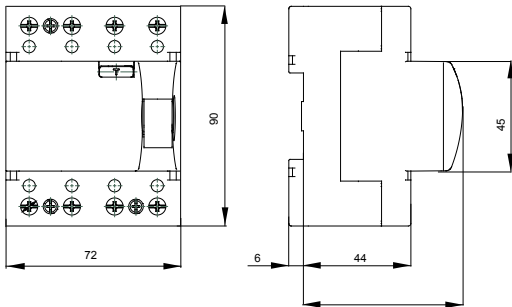

| | |
|---|----------------------------------|
| Description | RESIDUAL CURRENT CIRCUIT BREAKER |
| Code | SD |
| No. of poles | 4P |
| No. modules | 4 |
| Rated current | 125 A |
| Rated residual operating current | 300 mA |
| Type | AC |
| Rated voltage (EN/IEC 61008-1, 61008-2-1) | 400/415 V |

| | | | |
|---------------------------|----------------------------------|--|------------|
| Standard | IEC/EN 61008-1, IEC/EN 61008-2-1 | Rated frequency (Hz) | 50Hz |
| Insulation voltage (Ui) | 500 V | Rated impulse withstand voltage (Uimp) | 4 kV |
| Overvoltage category | III | Level of immunity (8/20 μs) | 250 A |
| Section rigid cable | <50 | Section flexible cable | <50 |
| Rated tightening torque | 3 Nm | Double connection | No |
| Operating temperature | -25 +40 °C | Stocking temperature | -40 +70 °C |
| Electrical endurance | ≥ 10.000 | Mechanical endurance | ≥ 10.000 |
| Auxiliaries compatibility | Yes | ReStart compatibility | No |
| Assembly position | Any | | |

DIMENSIONAL



WIRING DIAGRAM

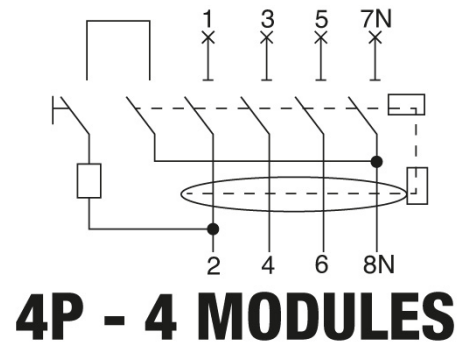

STANDARDS/APPROVALS

