

Product Data Sheet

GW21071

SYSTEM BLACK - Domestic range



The System modular devices allow the creation of infinite combinations of devices and plates, through a complete range that covers all design, functional and installation needs. Colours and finishes: satin black, elegant and classy. The range includes control units, socket-outlets, breakers, indicators, connectors and devices for the control, safety and comfort of your home.

| | | | |
|--|------------------------------|---|--------------------------------|
| Category | Relay | Output contacts | 10 AX 250V ac |
| Description | Step-step 1P | Colour | Black |
| No. of poles | 1 | Voltage | 230 V ac |
| Standard | EN 60669-1 / EN 60669-2-2 | Frequency | 50Hz |
| Resistance at test voltage | 2000 V at 50 Hz for 1 minute | Insulation resistance | > 5 MOhm |
| Wiring terminals | With screw | Prolonged operation switch (no.of position changes) | 40.000 at In 250 V ac cosφ=0,6 |
| Thermo-pressure with ball | 125 °C | Glow Wire Test | 850 °C |
| Terminal grip on cable traction | > 50 N | Terminal tightening capacity stranded cables (mm²) | 1x4 / 2x2,5 |
| Terminal tightening capacity solid cables (mm²) | 2x2,5 | No. SYSTEM modules | 1 |
| Rated power (AC1) | 0 VA | Rated power (AC15) | 0 VA |
| 230V incandescent/halogen lamps | 800 W | Fluorescent lamps with electronic ballast | 400 W |
| Fluorescent lamps with compensated ballast | 360 W | CFL lamps | 200 W |
| 230V LED lamps | 200 W | Halogen/LED lamps with electronic transformer | 200 W |
| Halogen/LED lamps with electromechanical transformer | 400 W | Material | Technopolymer |
| Electrocod | 140 | | |

DIMENSIONAL

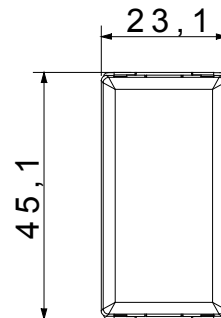
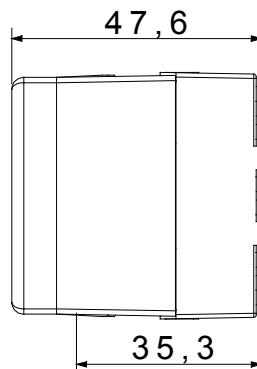
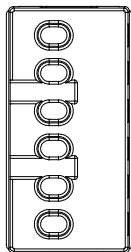

TECHNICAL SYMBOLOGY



STANDARDS/APPROVALS

