



STADIUM PRO 3 is a high power LED floodlight, with an LES (light emitted surface) high emission, suitable for lighting sports facilities for professional competitive competitions. The spotlight has a graphite grey finish with trivalent treatment for maximum resistance to oxidation and is equipped with an integrated "self-cleaning" thermal dissipation system. It consists of three modules, each with a venting and non-condensing valve, protected from accidental impacts. The rotation system between the bracket and the optical modules is truncated-conical in aluminium with an integrated goniometer within the bracket for easy orientation control and fixing by means of a grub-screw, which ensure the tightness over time of each individual module. The spotlight is available in 4,000K or 5,700K colour temperatures and CRI>70, CRI>80 or CRI>90 (TLCI>80) colour rendering. The range also includes 6 types of circular optics, from 8° to 40°, 1 symmetrical/Elliptical optic and 2 asymmetric optics. The T.I.R.Ex optical system developed by GEWISS, with high transparency PMMA HT lenses, permits total control over the light beam, allowing for wide flexibility in the design environment, with high qualitative and quantitative performance. The power supply box can be fixed on the edge-bracket, or remotely, it is immune to surges of up to 10KV both in RCCB and common mode, with a single cable. The range includes a DALI2 or DMX-RDM power supply, to allow maximum flexibility in the creation of even complex light sets.

Stadium Pro is for a professional use hence the photometric data are not disclosed. We invite you to take contact with our technical and commercial teams.

#### GENERAL INFORMATION

|                                  |   |
|----------------------------------|---|
| Context                          | Professional sport lighting                     |
| Luminaire                        | High power LED floodlight                       |
| Application                      | Indoor / Outdoor                                |
| Unique digital code (Datamatrix) | Currently not present                           |
| Colour                           | Graphite grey                                   |
| Type of light source             | LED   |
| System power                     | 1450 W  |
| LED Lifetime                     | L90B10(Tq25°C)=40.000h; L80B10 (Tq25°C)=75.000h |
| Weight (kg)                      | 30  |

|                       |            |
|-----------------------|------------|
| Warranty              | 5 years    |
| Stocking temperature  | -          |
| Operating temperature | -25 +50 °C |

#### MATERIALS

|                |                           |
|----------------|---------------------------|
| Body           | Die-cast aluminium        |
| Shield type    | Flat tempered glass 4mm   |
| Optic          | T.I.R.Ex. Optical PMMA HT |
| Gasket         | Anti-aging silicone       |
| Locking Hook   | -                         |
| External screw | Stainless steel           |

|        |                         |
|--------|-------------------------|
| Colour | Polyester powder coated |
|--------|-------------------------|

#### STANDARDS AND APPROVALS

|   |           |
|---|-----------|
| Classification                          | -         |
| Device with reduced surface temperature | -         |
| DIN 18032-3 certification               | Available |
| IPEA                                    | -         |
| Insulation class                        | I         |
| IP degree                               | IP66      |
| Mechanical resistance                   | IK08      |
| Glow Wire Test                          | -         |

#### OPTIC AND ILLUMINATING FEATURES

|                                    |  |
|------------------------------------|--|
| Optic                              | Circular 40°                                 |
| Unified Glare Rating               | ULOR = 0%                                    |
| Lumen output (lm)                  | 160000                                       |
| Efficacy (lm/W)                    | 110  |
| Colour temperature                 | 4000 K                                       |
| Colour Rendering Index             | CRI70  |
| Standard Deviation Colour Matching | SDCM = 5                                     |
| Photobiological Risk Class         | -  |
| Standard                           | EN60598-1; EN60598-2-5; IEC 62471; IEC 62778 |

#### ELETRICAL AND LIGHTING FEATURES

|                        |                          |
|------------------------|--------------------------|
| Supply voltage         | See external supply unit |
| Rated frequency (Hz)   | See external supply unit |
| Driver                 | To be ordered separately |
| Driver failure rate    | See external supply unit |
| Overvoltage protection | See external supply unit |
| Control System         | See external supply unit |

#### INSTALLATION AND MAINTENANCE

|                           |  |
|---------------------------|--|
| Mounting and installation | Lighting tower - Surface                             |
| Tilt                      | Rotation on bracket with integrated goniometer       |
| Wiring                    | Multipolar cable between floodlight and power supply |

|                                     |                 |
|-------------------------------------|-----------------|
| Fixing                              | Bracket         |
| Light source replaceability         | By professional |
| Controlgear replaceability          | By professional |
| Driver Box                          | External        |
| Maximum surface exposed to the wind | 0,36 m²         |

## DIMENSIONAL

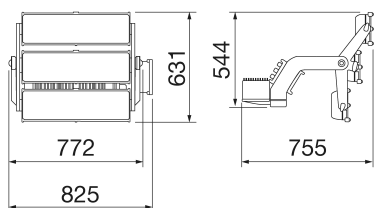

## PHOTOMETRIC DISTRIBUTION

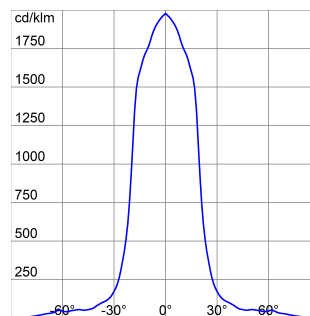



Product Data Sheet  
**GWP3331AF740**

STADIUM PRO

TECHNICAL SYMBOLOGY



0,36 m<sup>2</sup>



**IP**  
IP66

**IK**  
IK08

**GWT**  
-

STANDARDS/APPROVALS

