



The main supply boards for the construction site type 68 QP ACS and 68 CDK ACSK: installed immediately downstream from the energy meter, to protect the line from the delivery board to the main site distribution board. They are available in versions with power from 17 kW (32A) to 130 kW (250A), all fitted with an emergency push-button.

| | | | |
|---------------------------|--------------------------|---------------------------|------------------|
| Type | CDK ACS | board type | Wired |
| Colour | Grey RAL 7035 | Outer dim. LxHxD (mm) | 298x260x140 |
| Weight (kg) | 4 | Accordance with Standards | EN 61439-4 (ACS) |
| Characteristics | UV resistance (EN 62208) | IP degree | IP65 |
| Mechanical resistance | IK09 | Glow wire test | 650 °C |
| Thermo-pressure with ball | 70 °C | Insulation class | II |
| No. of poles | 4 | Power suppliable (kW) | 17 |
| Mains switch | MCB 32A 4P 6kA | MCB'S MT main RCCB | RCBO 32 A |
| Emergency push-button | Yes | Electrocod | 139 |

BEHAVIOUR WITH CHEMICAL AND ATMOSPHERIC AGENTS

| Saline solution | Acids | | Bases | | Solvents | | | | Mineral oil | UV rays |
|-----------------|---------------|--------------------|---------------|--------------------|--------------------|---------------|---------------|--------------------|--------------------|--------------------|
| | Concentrated | Diluted | Concentrated | Diluted | Hexane | Benzol | Acetone | Alcohol | | |
| Resistant | Not resistant | Limited resistance | Not resistant | Limited resistance | Limited resistance | Not resistant | Not resistant | Limited resistance | Limited resistance | Limited resistance |

DIMENSIONAL

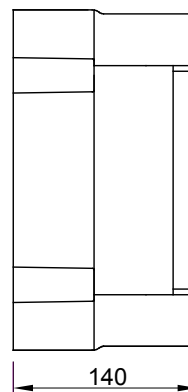
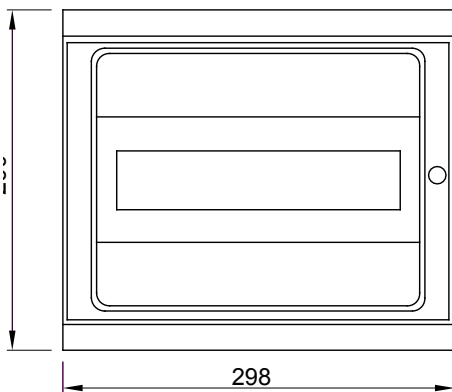

TECHNICAL SYMBOLOGY



STANDARDS/APPROVALS

