

IP degree		IP66	Mechanical resistance	> IK10
Houseable IB socket-outlets	Nr 2 IEC 309 16-32A IP44/67		Glow Wire Test	850 °C
Suitable for		Heavy duty	Electrocod	2222
Impact resistance at -20 °C		20 J		

DIMENSIONAL

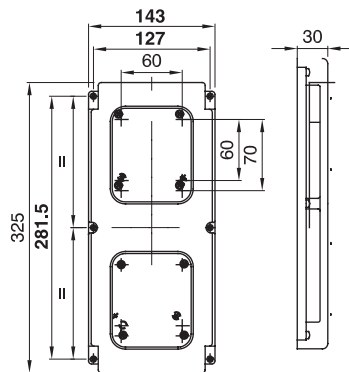

TECHNICAL SYMBOLOGY

IP **IK** **GWT**

IP66

> IK10

850 °C

STANDARDS/APPROVALS

