

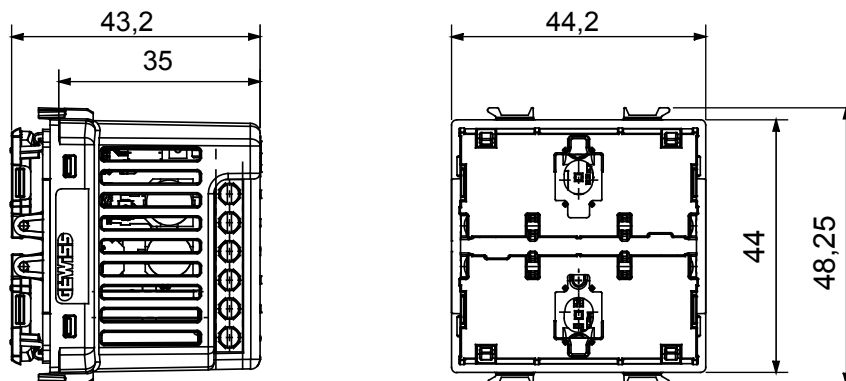

Wireless connected device with Zigbee protocol from the ChoruSmart system that can be with Home Gateway for "CONNECTED SMART HOME" solutions, for residential and small offices, both for new builds and renovations. Zigbee technology is a secure and reliable technology in which data is encrypted and every node in the network ensures reachability across all devices (mesh network).

| | | | |
|--|---|---|-------------------------------------|
| Power supply | 100 ÷ 240 V ac - 50/60 Hz | No. of channels | 2 |
| No. modules | 2 | Radio connections | Zigbee (IEEE 802.15.4) |
| Standard | - | Working temperature | -5 ÷ +45 °C |
| Relative humidity (non-condensative) | Max 93% | Power output Zigbee | 10 dBm |
| Wiring terminals | With screw | Terminal tightening capacity stranded cables (mm²) | Max. 1,5 |
| Terminal tightening capacity solid cables (mm²) | Max. 1,5 | Category | 2-channel push-button control panel |
| No. input channels | 2 (for local command replication or sending additional Zigbee commands) | Input voltage | Mains supply voltage |
| IP degree | IP20 (with button key) | LED colour | Blue |
| Local control | Via 2 front push buttons (to complete with button key) | Power supply of EGO SMART plate | Yes |
| Zigbee control extension if installed on EGO SMART plate (with 2 front push buttons) | Yes | | |

DIMENSIONAL



TECHNICAL SYMBOLOGY

IP

IP20 (with button key)

STANDARDS/APPROVALS

