

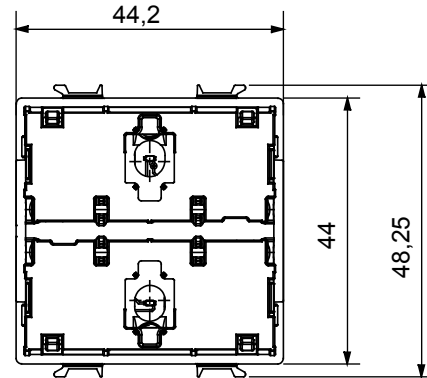

Flush-mounting axial roller shutter module. Device for commanding the motor that drives roller shutters, curtains, Venetian blinds, roller blinds, etc. via 2 interlocked output contacts with potential. Two axial push-buttons on the front for upward (UP) and downward (DOWN) movement, and for regulating the tilt of the slats. The device must be completed with the front buttons key available. The device has n°3 DIP-switches, located on the back of the device, for feature configuration.

Tanım	Axial roller shutter module	Besleme ünitesi	100 ÷ 240 V ac - 50/60 Hz
Modül sayısı	2	Giriş kanalı sayısı	2
Yerel kontrol	ön basmalı düğme aracılığıyla (düğme tuşuyla tamamlamak için)	Auxiliary input channel voltage	100 ÷ 240 V ac - 50/60 Hz
Depolama sıcaklığı	-25 ÷ +70 °C	N. of LED input channels	-
Kullanım sıcaklığı	-5 ÷ +45 °C	LED input channels voltage	-
Bağıl nem (yoğuşmasız)	Maks %93	Çıkış kanalı kanallar	2
Front light signaling	Mavi led	Çıkış kontakları	n. 2 x 2,3 A cosφ 0,6
Kablolama terminalleri	Vidalı	240 V ac Incandescent-halogen lamps	-
Terminal sıkıştırma kapasitesi esnek kablolar (mm²)	Maks. 1,5	240 V ac LED lamps	-
Terminal sıkıştırma kapasitesi sert kablolar (mm²)	Maks. 1,5	Loads piloted from electronic transf. 240 V ac	-
Bağlam	Dry indoor places	240 V Floresan lambalar	-
IP derecesi	IP20 (with button key)	Yükleme kontrolü	-
Standart	2014/35/EU (LVD), 2014/30/EU (EMC), 2011/65/EU + 2015/863 (RoHS), EN 60669-2-1, EN 60669-1, EN IEC 63000		

DIMENSIONAL

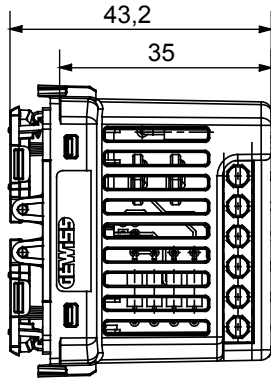

TECHNICAL SYMBOLOGY

IP

IP20 (with button key)

STANDARDS/APPROVALS

