

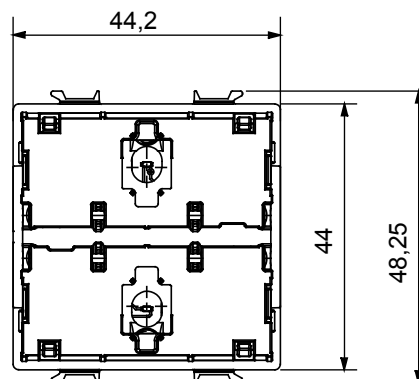

Flush-mounting axial roller shutter module. Device for commanding the motor that drives roller shutters, curtains, Venetian blinds, roller blinds, etc. via 2 interlocked output contacts with potential. Two axial push-buttons on the front for upward (UP) and downward (DOWN) movement, and for regulating the tilt of the slats. The device must be completed with the front buttons key available. The device has n°3 DIP-switches, located on the back of the device, for feature configuration.

Descriere	Axial roller shutter module	Alimentare electrică	100 ÷ 240 V c.a. - 50/60 Hz
Nr. module	2	Nr. canale de intrare	2
Comandă locală	Prin 2 butoane frontale (pentru a finaliza cu tasta buton)	Tensiune canal intrare auxiliară	100 ÷ 240 V c.a. - 50/60 Hz
Temperatura de stocare	-25 ÷ +70 °C	N. of LED input channels	-
Temperatura de lucru	-5 ÷ +45 °C	LED input channels voltage	-
Umiditate relativă (necondensată)	Max. 93%	Nr. canale de ieșire	2
Semnalizare cu lumină frontală	LED albastru	Contacte ieșire	n. 2 x 2,3 A cosφ 0,6
Borne de cablare	Conținut	Lămpi cu halogen incandescent de 240 V c.a.	-
Capacitate de strângere borne cabluri torsadate (mm²)	Max 1,5	Lămpi LED de 240 V c.a.	-
Capacitate de strângere a bornelor cabluri solide (mm²)	Max 1,5	Sarcini pilotate de la transformatoare electronice 240 V c.a.	-
Context	Dry indoor places	Lămpi fluorescente de 240 V	-
Grad IP	IP20 (cu buton)	Controlul sarcinii	-
Standard	2014/35/EU (LVD), 2014/30/EU (EMC), 2011/65/EU + 2015/863 (RoHS), EN 60669-2-1, EN 60669-1, EN IEC 63000		

DIMENSIONAL

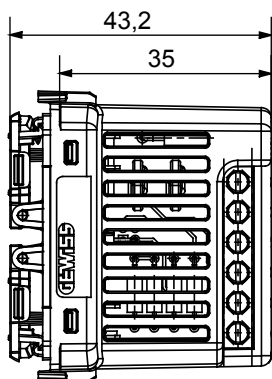

TECHNICAL SYMBOLOGY

IP

IP20 (cu buton)

STANDARDS/APPROVALS

