

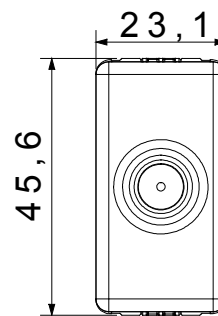

The System modular devices make it possible to create infinite combination between devices and plates, thanks to a complete range that is able to satisfy all design, functional and installation requirements. Colour and finiture: glossy white, bright and versatile  
The range includes commands, socket- outlets, protection, indicators, connectors and devices for the control, safety and comfort of your home.

Kategorie	TV-SAT Dose	Beschreibung	Durchgangsdose
Typ	-	Farbe	Weiss
Dämpfungswerte	14 dB	Frequenz	5-2400 MHz
Schirmung	Klasse A	Für Verbinder Typ	F-Buchse
Norm	EN 60728-4; IEC 61169-24	Anz. SYSTEM Module	1
Kabelfixierung	Mit Schrauben	Gehäuse	Zamak-Metallkörper aus Druckguss
Material	Technopolymer	Electrocod	0131

### Abmessungen

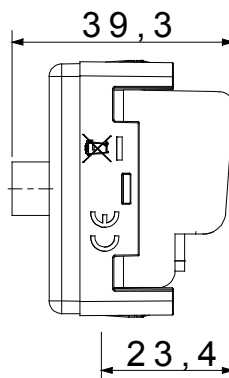
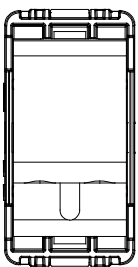

### Normen / Richtlinien

