

Light rigid conduits RK9 range, made of PVC, classification 22211, available in the following versions:  
 2 m length, grey RAL 7035 colour and five diameters, from 16 to 40 mm with sleeved end;  
 3 m length, grey RAL 7035 colour and six diameters, from 16 to 50 mm with straight end or sleeved end;  
 3 m length, white RAL 9010 colour and five diameters, from 16 to 40 mm with straight end.  
 Suitable for electrical and/or data transmission systems and to be installed in uncrowded areas. They represent the best solution for those who do not require a high impact resistance but at the same time do not want to compromise on quality. They can be integrated with spiraled sheaths and wall mounting enclosures. Completing the offer, a wide range of accessories and routing components from IP40 to IP67 protection rating. The RK9 conduits comply with Product Standard EN 61386-1 and EN 61386-21.

|   |  |   |   |
|---|--|---|---|
| Colour  | Grey RAL 7035                                  | Material  | PVC   |
| Length (m)  | 3  | Conduits Ø (mm)   | 40  |
| Glow Wire Test  | 960 °C   | Resistance to compression                                       | 2 (Light - 320 N)                           |
| Resistance to impact  | 2 (Light - 320 N)                              | Resistance to bending   | 1 (Rigid)                                   |
| Electrical characteristics                                      | 2 (With electrical insulating characteristics) | Protection against ingress of solid objects without accessories | 0   |
| Protection against ingress of water objects without accessories | 0  | Resistance against corrosion                                    | Not applicable to plastic conduit systems   |
| Fire resistance   | 1 (Non-flame propagating)                      | Protection against ingress of solid objects with accessories    | 4/6<br>(It depends on the accessories used) |
| Protection against ingress of water with accessories            | 0/5/7<br>(It depends on the accessories used)  | Standard  | EN 61386-1 EN 61386-22                      |
| Family  | RK9  | Classification  | 22211                                       |

### DIMENSIONAL

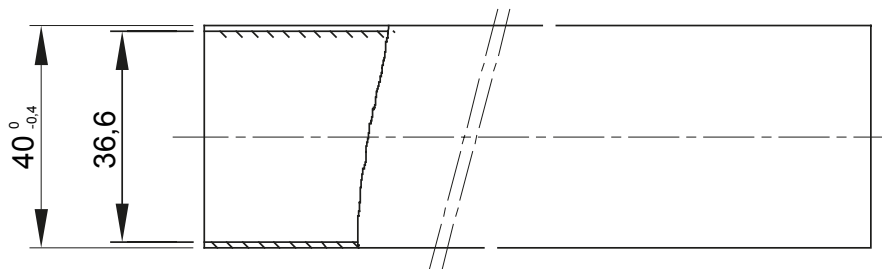
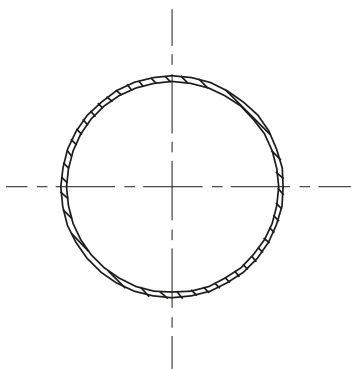

### TECHNICAL SYMBOLOGY



### STANDARDS/APPROVALS

