

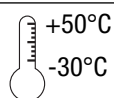

**IP66
IP69**

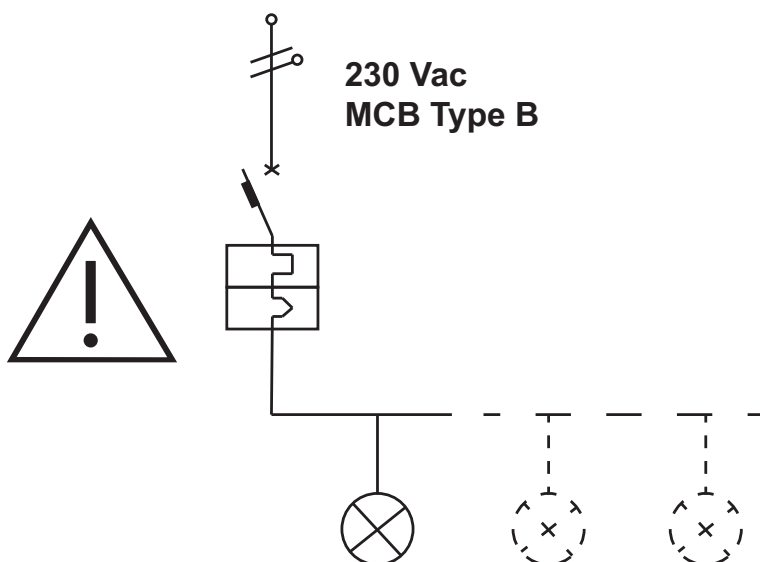

$t_a^{+50^\circ\text{C}} / t_q^{+25^\circ\text{C}}$



MCB current	10 A	16 A	20 A
max no. SMART [3]:	13	25	31

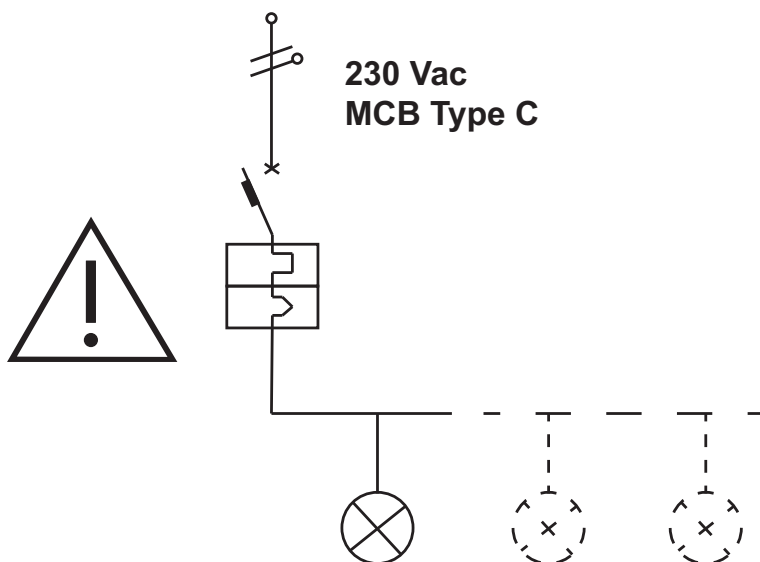

MCB current	10 A	16 A	20 A
max no. SMART [3]:	31	49	62

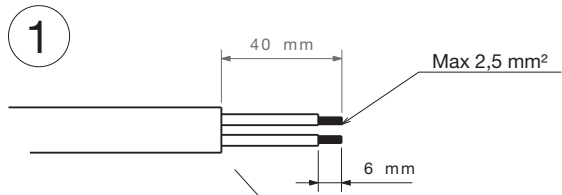

3 = L
1 = N

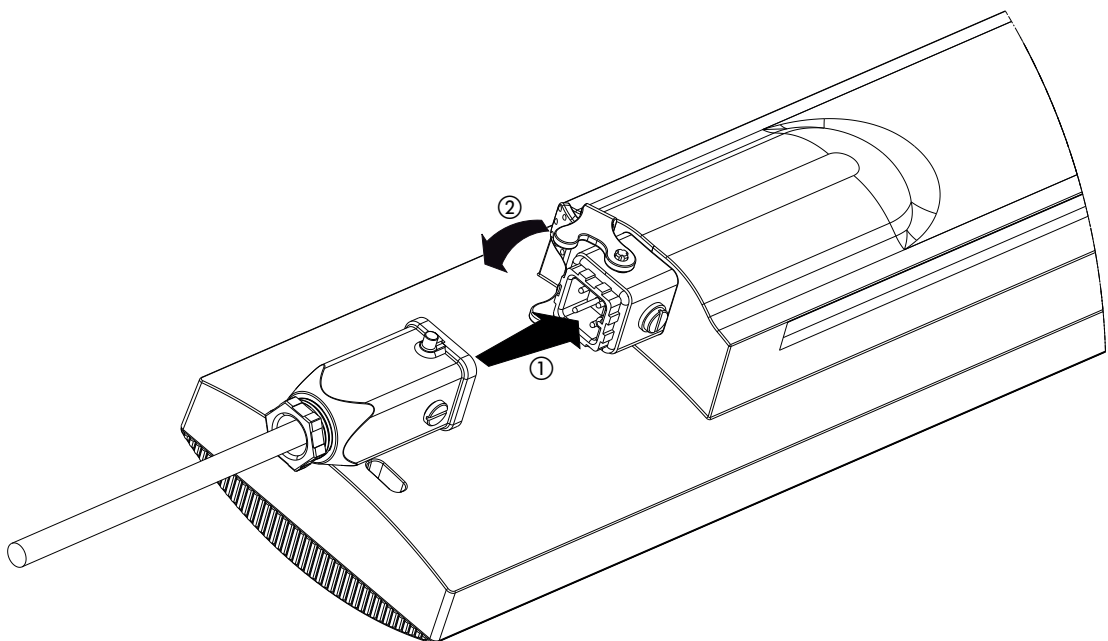
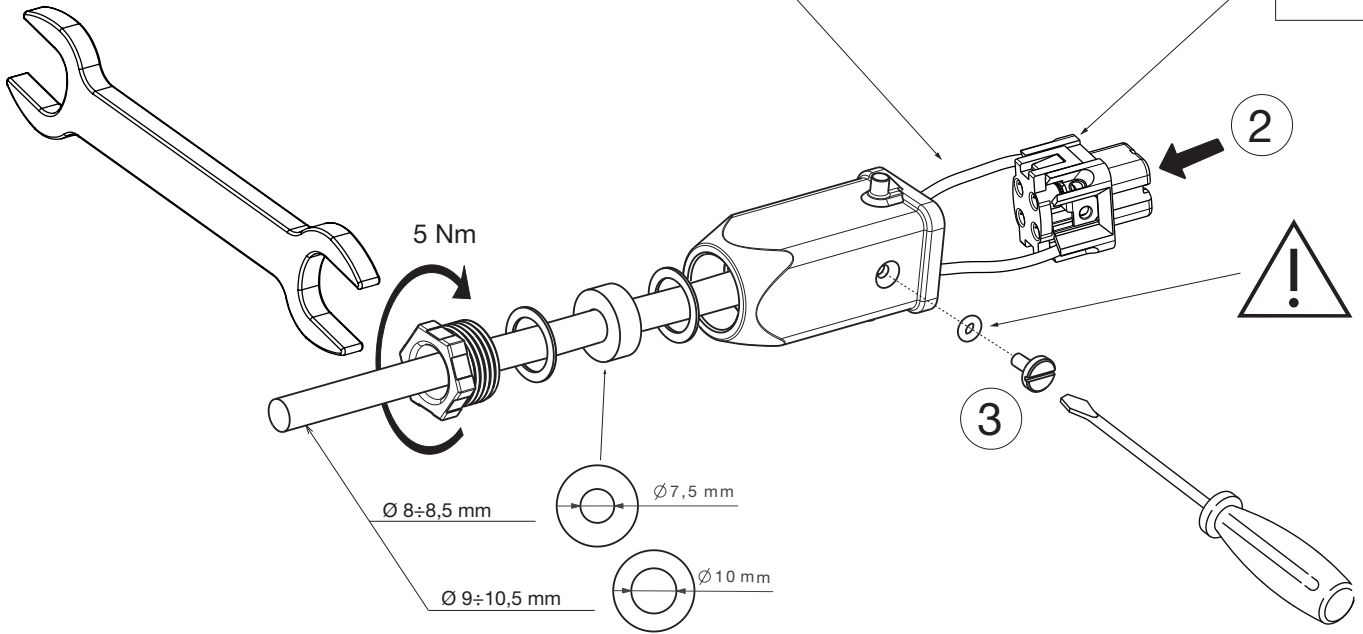

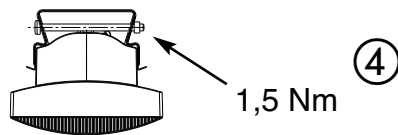
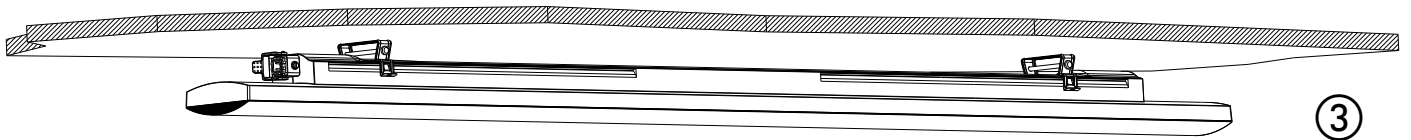
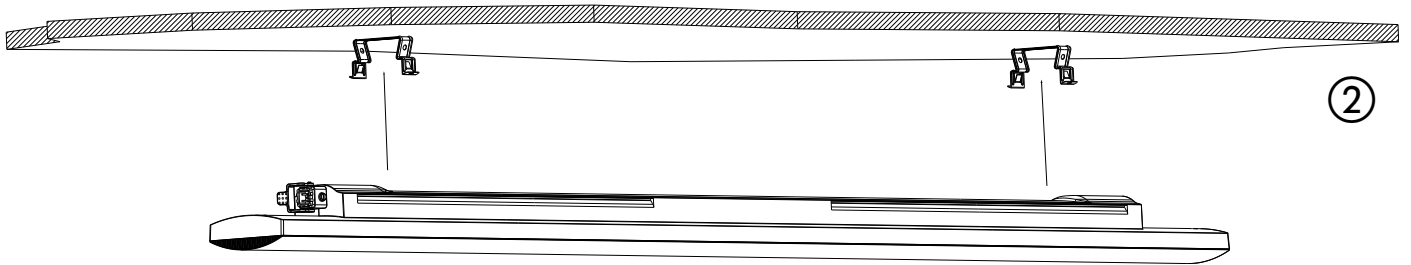
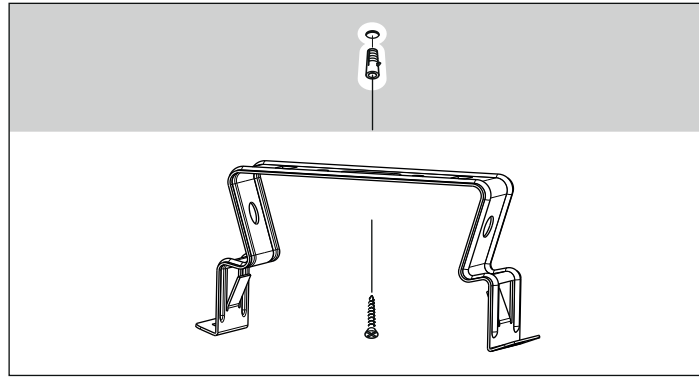

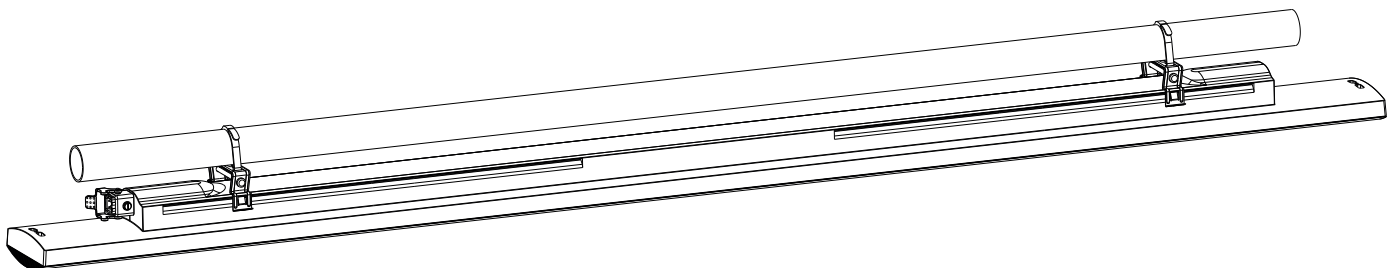
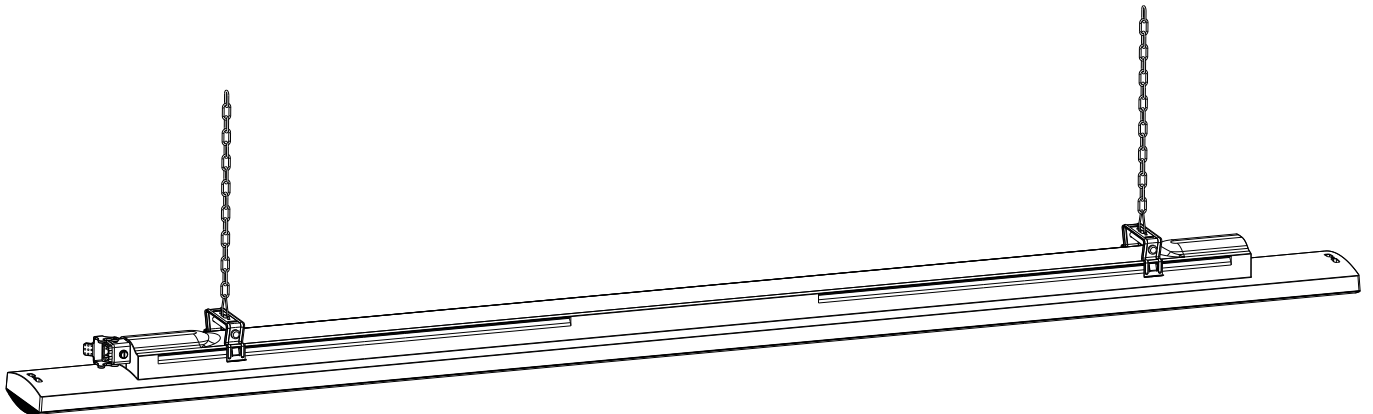
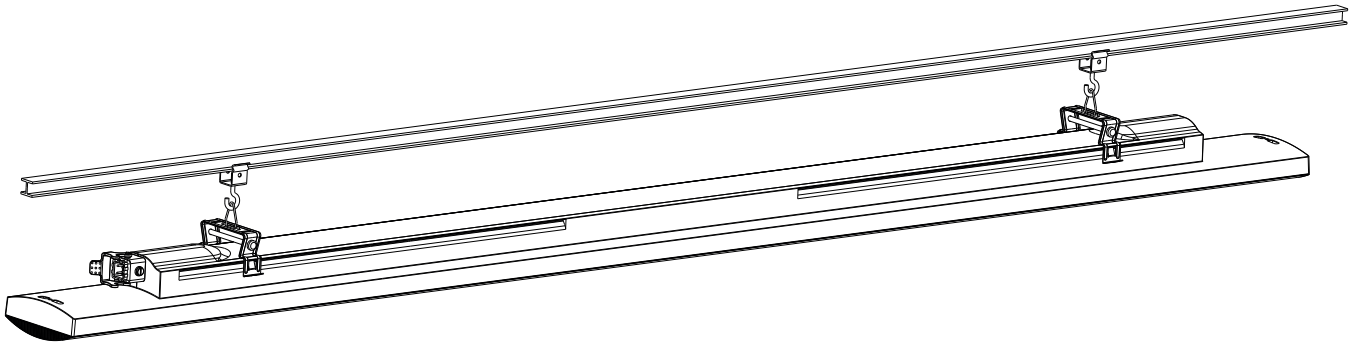
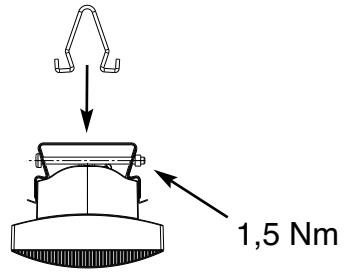

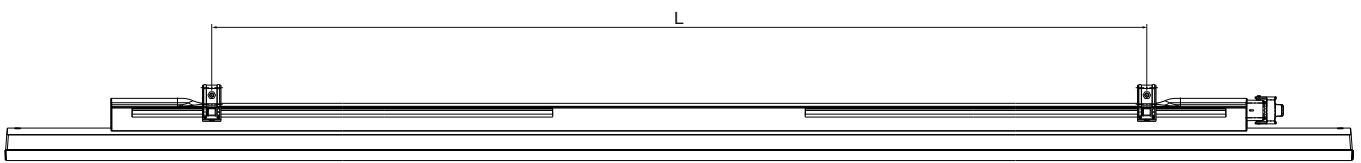
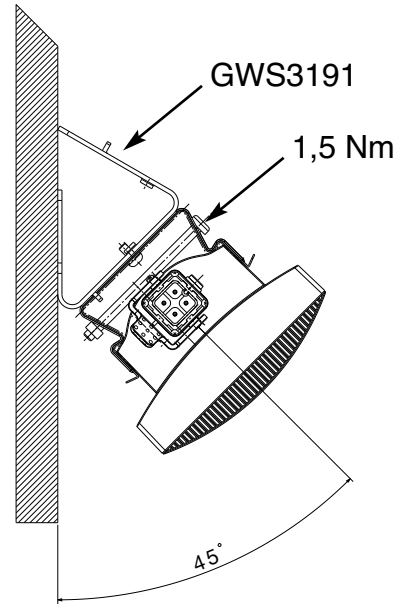
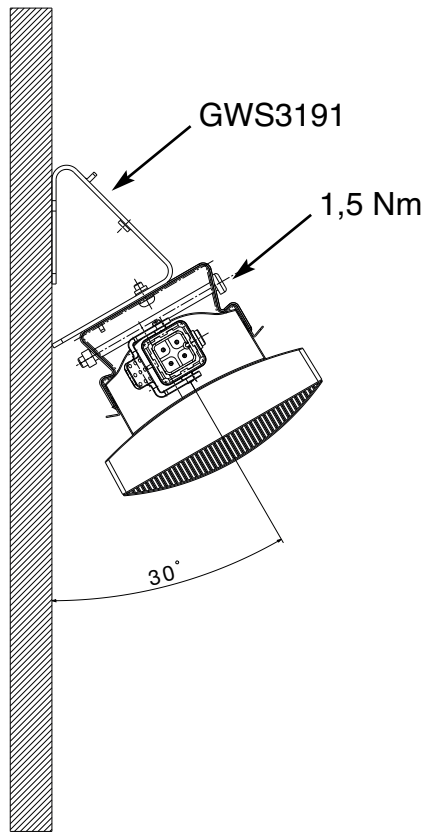

	L
SMART [3] 800	250÷475 mm
SMART [3] 1200	350÷910 mm
SMART [3] 1600	500÷1270 mm

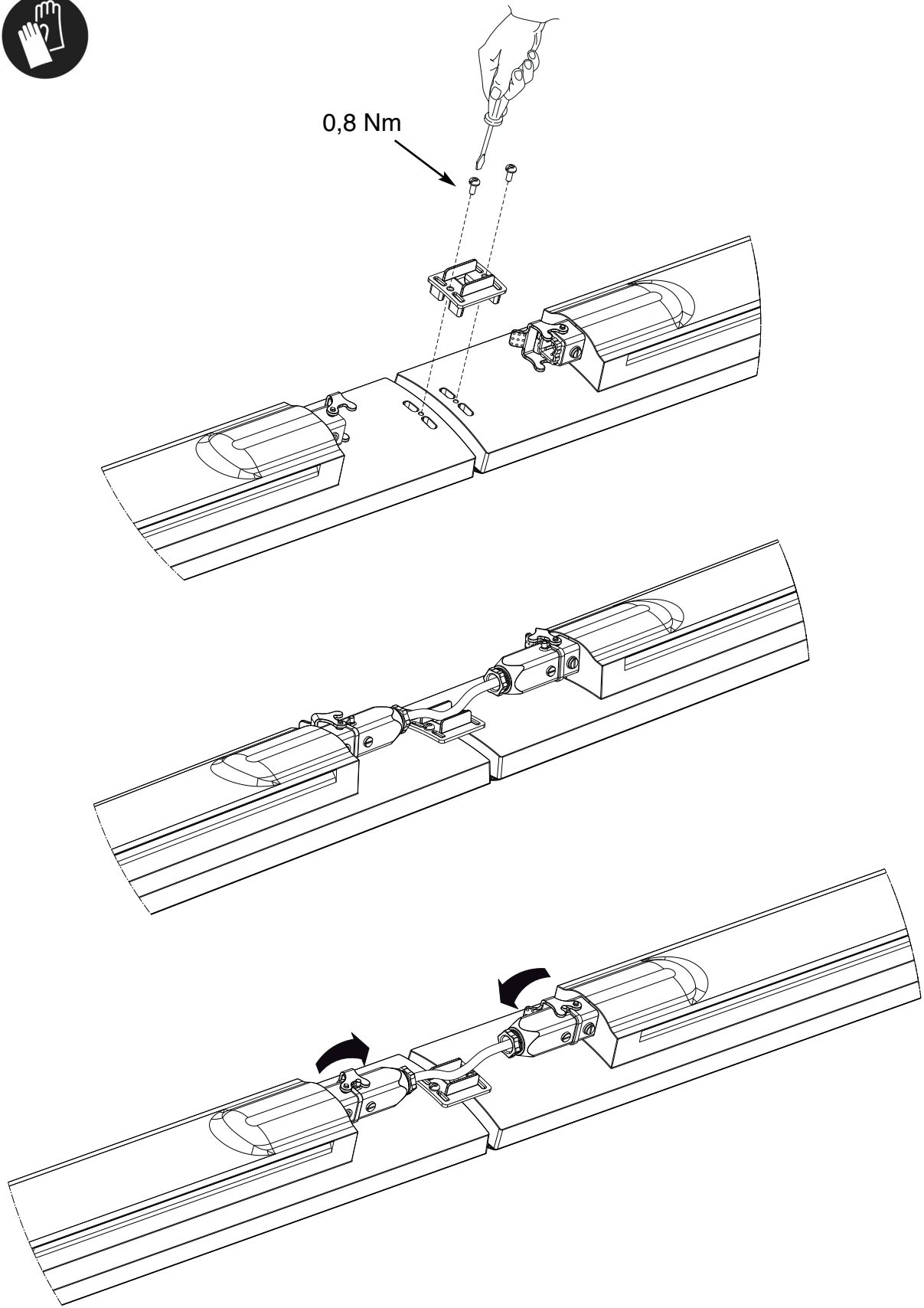

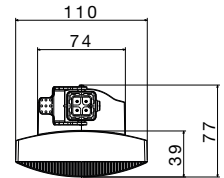
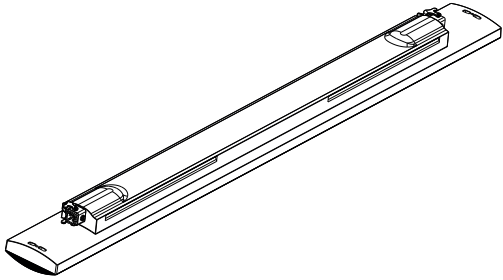
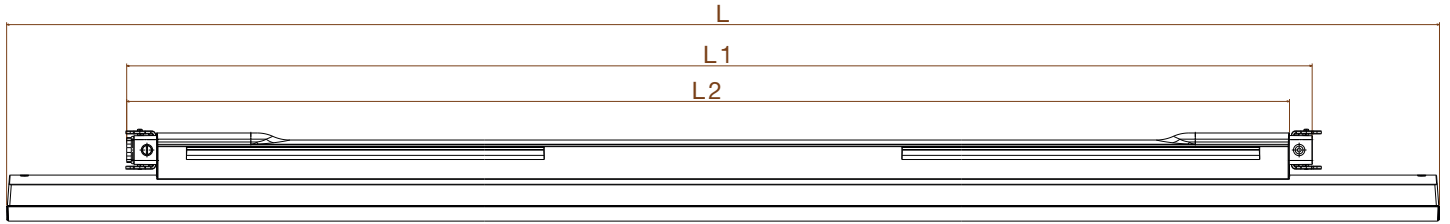

	L	L1	L2
SMART [3] 800	800	//	550
SMART [3] 1200	1200	//	970
SMART [3] 1600	1600	//	1370
SMART [3] 1200 LP	1200	990	//
SMART [3] 1600 LP	1600	1390	//

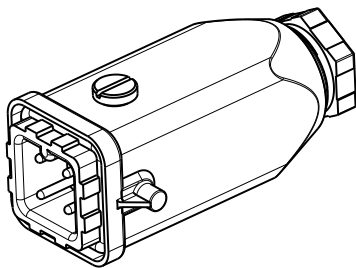

GWS3192

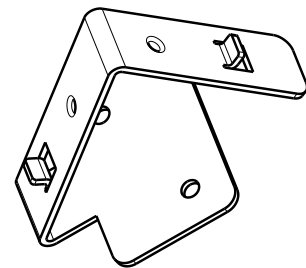

GWS3191

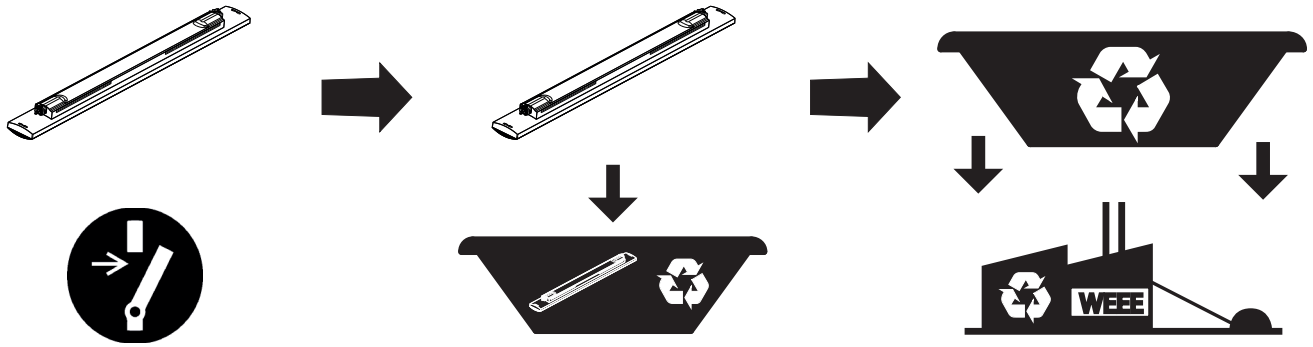

Ai sensi delle Decisioni e delle Direttive Europee applicabili, si informa che il responsabile dell'immissione del prodotto sul mercato Comunitario è:
According to the applicable Decisions and European Directives, the responsible for placing the apparatus on the Community market is:

GEWISS S.p.A. Via A.Volta, 1 IT-24069 Cenate Sotto (BG) Italy Tel: +39 035 946 111 Fax: +39 035 946 270 E-mail: qualitymarks@gewiss.com



 **+39 035 946 111**
8.30 - 12.30 / 14.00 - 18.00
lunedì ÷ venerdì - monday ÷ friday

 **+39 035 946 260**

 **sat@gewiss.com**
www.gewiss.com