

Technical specifications

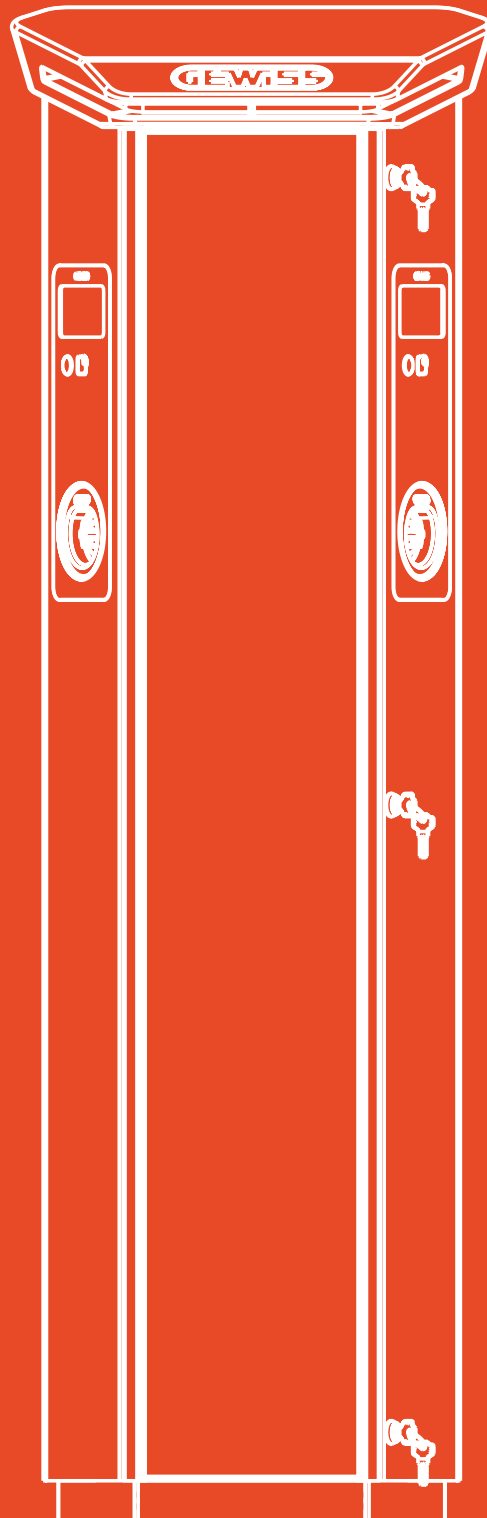

WALLBOXES FOR CORPORATE SCENARIOS

CODE	GWJ2402T	GWJ2404T
Charging mode	Mode 3	Mode 3
Charging sockets	Type 2	Type 2
Connector type	Fixed vandal-proof socket (IPxxD)	Fixed vandal-proof socket (IPxxD)
Cable length (if available)	-	-
ELECTRICAL SPECIFICATIONS		
Input		
Power supply (in-out)	3 x 70 mm ²	5 x 70 mm ²
Rated current	64A	64A
Total Power	14.8 kW	44 kW
Output		
Rated Voltage	230V	400V
Total Maximum Current	32A + 32A	32A + 32A
Maximum Power	7.4 kW + 7.4 kW	22 kW + 22 kW
Thermal-magnetic protection	40A - 2P - D Curve	40A - 4P - D Curve
RCCB protection	40A - 2P - Type A	40A - 4P - Type A
User protection	DC Leakage 6 mA	DC Leakage 6 mA
Energy Metering	-	-
FUNCTIONAL FEATURES		
Connectivity	WiFi/Ethernet	WiFi/Ethernet
Communication	OCPP 1.6 J	OCPP 1.6 J
Load Management	DLM with Solar Boost / via cloud with OCPP	DLM with Solar Boost / via cloud with OCPP
Charging Activation	APP/RFID	APP/RFID
Human Interface	4.3" graphic display	4.3" graphic display
Master/Slave	Yes	Yes
Over-the-air updates	Yes	Yes
Programmable Remote Contact	Yes	Yes
Local directives	-	-
MECHANICAL PROPERTIES		
Installation Type	Wall- / Pole-mounting	
Materials	Steel sheet	
Exterior colour	Grey Chassis, Cap RAL7011	
Surface treatment	Anti-corrosion surface painting	
Protection Rating	IP55	
Impact Resistance Rating	IK10	
Operating temperature	Operating temperature -25°C / +55°C	
AVAILABLE ACCESSORIES		
RFID card	GWJ8002	
4G Modem KIT	GWJ8013	
Pole support kit	GW46551	
CT DLM load management kit	GWD6809 for current above 100A	

WALLBOXES FOR SEMI-PUBLIC OR PUBLIC SCENARIOS

CODE	GWJ2502T	GWJ2504T	GWJ2502TK	GWJ2504TK	GWJ2502TF	GWJ2504TF
Charging mode	Mode 3	Mode 3	Mode 3	Mode 3	Mode 3	Mode 3
Charging sockets	Type 2	Type 2	Type 2	Type 2	Type 2	Type 2
Connector type	Fixed vandal-proof socket (IPxxD)	Fixed vandal-proof socket (IPxxD)	Fixed vandal-proof socket (IPxxD)	Fixed vandal-proof socket (IPxxD)	Fixed vandal-proof socket (IPxxD)	Fixed vandal-proof socket (IPxxD)
Cable length (if available)	-	-	-	-	-	-
ELECTRICAL SPECIFICATIONS						
Input						
Power supply (in-out)	3 x 70 mm ²	5 x 70 mm ²	3 x 70 mm ²	5 x 70 mm ²	3 x 70 mm ²	5 x 70 mm ²
Rated current	64A	64A	64A	64A	64A	64A
Total Power	14.8 kW	44 kW	14.8 kW	44 kW	14.8 kW	44 kW
Output						
Rated Voltage	230V	400V	230V	400V	230V	400V
Total Maximum Current	32A + 32A	32A + 32A	32A + 32A	32A + 32A	32A + 32A	32A + 32A
Maximum Power	7.4 kW + 7.4 kW	22 kW + 22 kW	7.4 kW + 7.4 kW	22 kW + 22 kW	7.4 kW + 7.4 kW	22 kW + 22 kW
Thermal-magnetic protection	40A - 2P - D Curve	40A - 4P - D Curve	40A - 2P - D Curve	40A - 4P - D Curve	40A - 2P - D Curve	40A - 4P - D Curve
RCCB protection	40A - 2P - Type A	40A - 4P - Type A	40A - 2P - Type A	40A - 4P - Type A	40A - 2P - Type A	40A - 4P - Type A
User protection	DC Leakage 6 mA	DC Leakage 6 mA	DC Leakage 6 mA	DC Leakage 6 mA	DC Leakage 6 mA	DC Leakage 6 mA
Energy Metering	MID meter	MID meter	MID meter	MID meter	MID meter	MID meter
FUNCTIONAL FEATURES						
Connectivity	WiFi/Ethernet	WiFi/Ethernet	WiFi/Ethernet	WiFi/Ethernet	WiFi/Ethernet	WiFi/Ethernet
Communication	OCPP 1.6 J	OCPP 1.6 J	OCPP 1.6 J	OCPP 1.6 J	OCPP 1.6 J	OCPP 1.6 J
Load Management	DLM with Solar Boost / via cloud with OCPP	DLM with Solar Boost / via cloud with OCPP	DLM with Solar Boost / via cloud with OCPP	DLM with Solar Boost / via cloud with OCPP	DLM with Solar Boost / via cloud with OCPP	DLM with Solar Boost / via cloud with OCPP
Charging Activation	APP/RFID	APP/RFID	APP/RFID	APP/RFID	APP/RFID	APP/RFID
Human Interface	4.3" graphic display	4.3" graphic display	4.3" graphic display	4.3" graphic display	4.3" graphic display	4.3" graphic display
Master/Slave	Yes	Yes	Yes	Yes	Yes	Yes
Over-the-air updates	Yes	Yes	Yes	Yes	Yes	Yes
Programmable Remote Contact	Yes	Yes	Yes	Yes	Yes	Yes
Local directives	-			PEN / OZEV		TIC
MECHANICAL PROPERTIES						
Installation Type	Wall- / Pole-mounting					
Materials	Steel sheet					
Exterior colour	Grey Chassis, Cap RAL7011					
Surface treatment	Anti-corrosion surface painting					
Protection Rating	IP55					
Impact Resistance Rating	IK10					
Operating temperature	Operating temperature -25°C / +55°C					
AVAILABLE ACCESSORIES						
RFID card	GWJ8002					
4G Modem KIT	GWJ8013					
Pole support kit	GW46551					
CT DLM load management kit	GWD6809 for current above 100A					

COLUMNS FOR SEMI-PUBLIC OR PUBLIC SCENARIOS

							
CODE	GWJ1502T	GWJ1504T	GWJ1514T	GWJ1502TK	GWJ1504TK	GWJ1502TF	GWJ1504TF
Charging mode	Mode 3	Mode 3	Mode 3	Mode 3	Mode 3	Mode 3	Mode 3
Charging sockets	Type 2	Type 2	Type 2	Type 2	Type 2	Type 2	Type 2
Connector type	Fixed vandal-proof socket (IPxxD)	Fixed vandal-proof socket (IPxxD)	Mobile connector	Fixed vandal-proof socket (IPxxD)	Fixed vandal-proof socket (IPxxD)	Fixed vandal-proof socket (IPxxD)	Fixed vandal-proof socket (IPxxD)
Cable length (if available)	-	-	4 m spiral	-	-	-	-
ELECTRICAL SPECIFICATIONS							
Input							
Power supply (in-out)	3 x 70 mm ²	5 x 70 mm ²	5 x 70 mm ²	3 x 70 mm ²	5 x 70 mm ²	3 x 70 mm ²	5 x 70 mm ²
Rated current	64A	64A	64A	64A	64A	64A	64A
Total Power	14.8 kW	44 kW	44 kW	14.8 kW	44 kW	14.8 kW	44 kW
Output							
Rated Voltage	230V	400V	400V	230V	400V	230V	400V
Total Maximum Current	32A + 32A	32A + 32A	32A + 32A	32A + 32A	32A + 32A	32A + 32A	32A + 32A
Maximum Power	7.4 kW + 7.4 kW	22 kW + 22 kW	22 kW + 22 kW	7.4 kW + 7.4 kW	22 kW + 22 kW	7.4 kW + 7.4 kW	22 kW + 22 kW
Thermal-magnetic protection	40A - 2P - D Curve	40A - 4P - D Curve	40A - 4P - D Curve	40A - 2P - D Curve	40A - 4P - D Curve	40A - 2P - D Curve	40A - 4P - D Curve
RCCB protection	40A - 2P - Type A	40A - 4P - Type A	40A - 4P - Type A	40A - 2P - Type A	40A - 4P - Type A	40A - 2P - Type A	40A - 4P - Type A
User protection	DC Leakage 6 mA	DC Leakage 6 mA	DC Leakage 6 mA	DC Leakage 6 mA	DC Leakage 6 mA	DC Leakage 6 mA	DC Leakage 6 mA
Energy Metering	MID meter	MID meter	MID meter	MID meter	MID meter	MID meter	MID meter
FUNCTIONAL FEATURES							
Connectivity	WiFi/Ethernet	WiFi/Ethernet	WiFi/Ethernet	WiFi/Ethernet	WiFi/Ethernet	WiFi/Ethernet	WiFi/Ethernet
Communication	OCPP 1.6 J	OCPP 1.6 J	OCPP 1.6 J	OCPP 1.6 J	OCPP 1.6 J	OCPP 1.6 J	OCPP 1.6 J
Load Management	DLM with Solar Boost / via cloud with OCPP	DLM with Solar Boost / via cloud with OCPP	DLM with Solar Boost / via cloud with OCPP	DLM with Solar Boost / via cloud with OCPP	DLM with Solar Boost / via cloud with OCPP	DLM with Solar Boost / via cloud with OCPP	DLM with Solar Boost / via cloud with OCPP
Charging Activation	APP/RFID	APP/RFID	APP/RFID	APP/RFID	APP/RFID	APP/RFID	APP/RFID
Human Interface	4.3" graphic display	4.3" graphic display	4.3" graphic display	4.3" graphic display	4.3" graphic display	4.3" graphic display	4.3" graphic display
Master/Slave	Yes	Yes	Yes	Yes	Yes	Yes	Yes
Over-the-air updates	Yes	Yes	Yes	Yes	Yes	Yes	Yes
Programmable Remote Contact	Yes	Yes	Yes	Yes	Yes	Yes	Yes
Local directives		-		PEN / OZEV			TIC
MECHANICAL PROPERTIES							
Installation Type	Floor-mounting (fixing base already included)			Floor-mounting (fixing base already included)			
Materials	Steel sheet			Steel sheet			
Exterior colour	Grey Chassis, Cap RAL7011			Grey Chassis, Cap RAL7011			
Surface treatment	Anti-corrosion surface painting			Anti-corrosion surface painting			
Protection Rating	IP55			IP55			
Impact Resistance Rating	IK11			IK11			
Operating temperature	Operating temperature -25°C / +55°C			Operating temperature -25°C / +55°C			
AVAILABLE ACCESSORIES							
RFID card	GWJ8002			GWJ8002			
4G Modem KIT	GWJ8013			GWJ8013			
Floor mounting plate	GWJ8021			GWJ8021			
CT DLM load management kit	GWD6809 for current above 100A			GWD6809 for current above 100A			

I-ON EVO

COLUMNS FOR CORPORATE SCENARIOS



CODE	GWJ1402T	GWJ1404T	GWJ1412T	GWJ1414T
Charging mode	Mode 3	Mode 3	Mode 3	Mode 3
Charging sockets	Type 2	Type 2	Type 2	Type 2
Connector type	Fixed vandal-proof socket (IPxxD)	Fixed vandal-proof socket (IPxxD)	Mobile connector	Mobile connector
Cable length (if available)	-	-	4 m spiral	4 m spiral
ELECTRICAL SPECIFICATIONS				
Input				
Power supply (in-out)	3 x 70 mm ²	5 x 70 mm ²	3 x 70 mm ²	5 x 70 mm ²
Rated current	64A	64A	64A	64A
Total Power	14.8 kW	44 kW	14.8 kW	44 kW
Output				
Rated Voltage	230V	400V	230V	400V
Total Maximum Current	32A + 32A	32A + 32A	32A + 32A	32A + 32A
Maximum Power	7.4 kW + 7.4 kW	22 kW + 22 kW	7.4 kW + 7.4 kW	22 kW + 22 kW
Thermal-magnetic protection	40A - 2P - D Curve	40A - 4P - D Curve	40A - 2P - D Curve	40A - 4P - D Curve
RCCB protection	40A - 2P - Type A	40A - 4P - Type A	40A - 2P - Type A	40A - 4P - Type A
User protection	DC Leakage 6 mA	DC Leakage 6 mA	DC Leakage 6 mA	DC Leakage 6 mA
Energy Metering	-	-	-	-
FUNCTIONAL FEATURES				
Connectivity	WiFi/Ethernet	WiFi/Ethernet	WiFi/Ethernet	WiFi/Ethernet
Communication	OCPP 1.6 J	OCPP 1.6 J	OCPP 1.6 J	OCPP 1.6 J
Load Management	DLM with Solar Boost / via cloud with OCPP	DLM with Solar Boost / via cloud with OCPP	DLM with Solar Boost / via cloud with OCPP	DLM with Solar Boost / via cloud with OCPP
Charging Activation	APP/RFID	APP/RFID	APP/RFID	APP/RFID
Human Interface	4.3" graphic display	4.3" graphic display	4.3" graphic display	4.3" graphic display
Master/Slave	Yes	Yes	Yes	Yes
Over-the-air updates	Yes	Yes	Yes	Yes
Programmable Remote Contact	Yes	Yes	Yes	Yes
Local directives	-			
MECHANICAL PROPERTIES				
Installation Type	Floor-mounting (fixing base already included)			
Materials	Steel sheet			
Exterior colour	Grey Chassis, Cap RAL7011			
Surface treatment	Anti-corrosion surface painting			
Protection Rating	IP55			
Impact Resistance Rating	IK11			
Operating temperature	Operating temperature -25°C / +55°C			
AVAILABLE ACCESSORIES				
RFID card	GWJ8002			
4G Modem KIT	GWJ8013			
Floor mounting plate	GWJ8021			
CT DLM load management kit	GWD6809 for current above 100A			

I-ON EVO

COLUMN

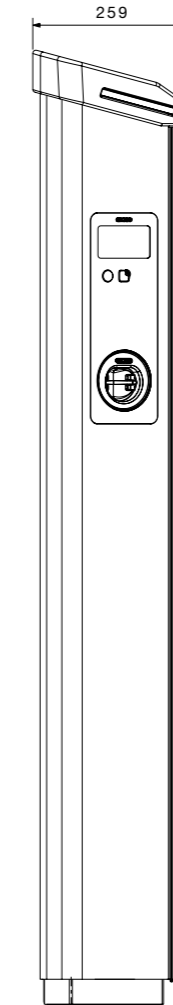
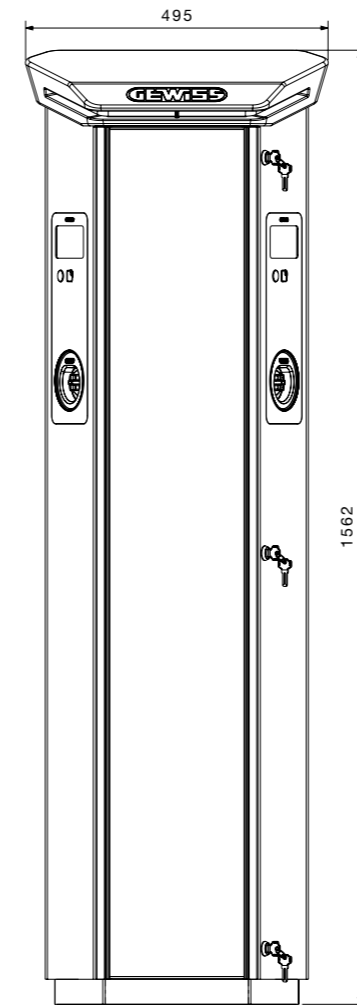

WALLBOX

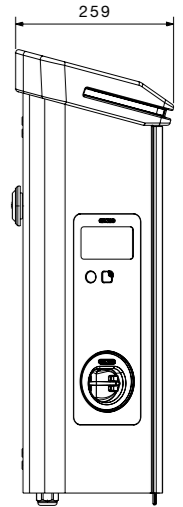
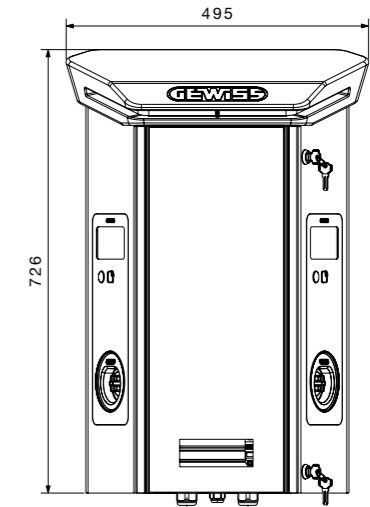

BACKEND CONNECTION SCHEME

EXAMPLE 1

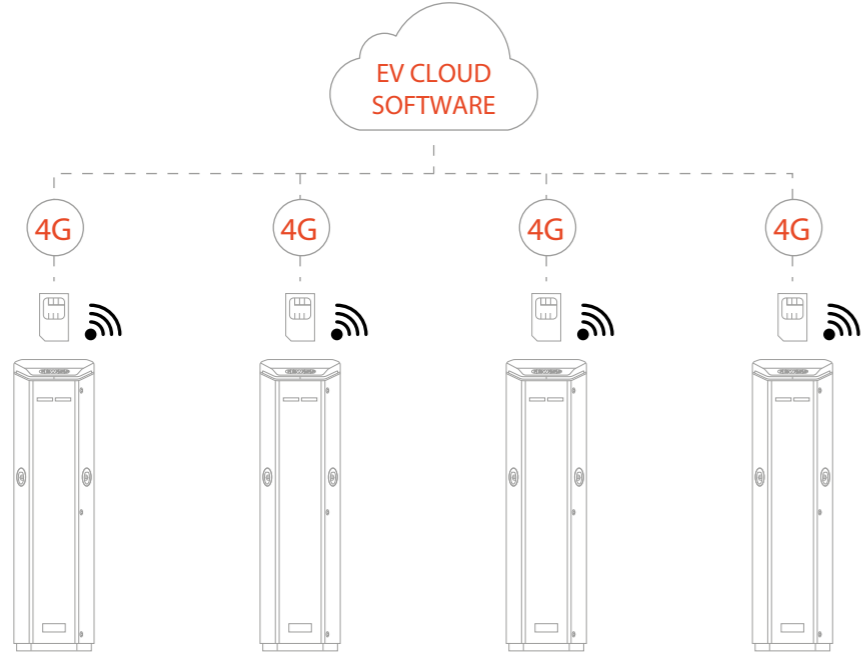

The charging stations can be equipped with a 4G Modem Kit and communicate “Peer To Peer” with the communication backend via the OCPP 1.6 JSON protocol.

EXAMPLE 2

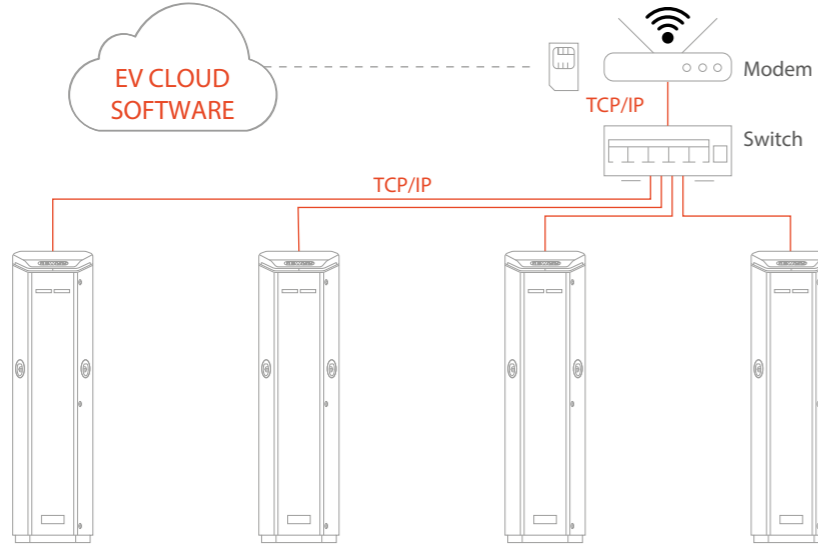

The charging stations are all equipped with Ethernet ports and can be wired to a switch in a star topology. Connectivity takes place through a router available in the system.

EXAMPLE 3 (MASTER / SLAVE)

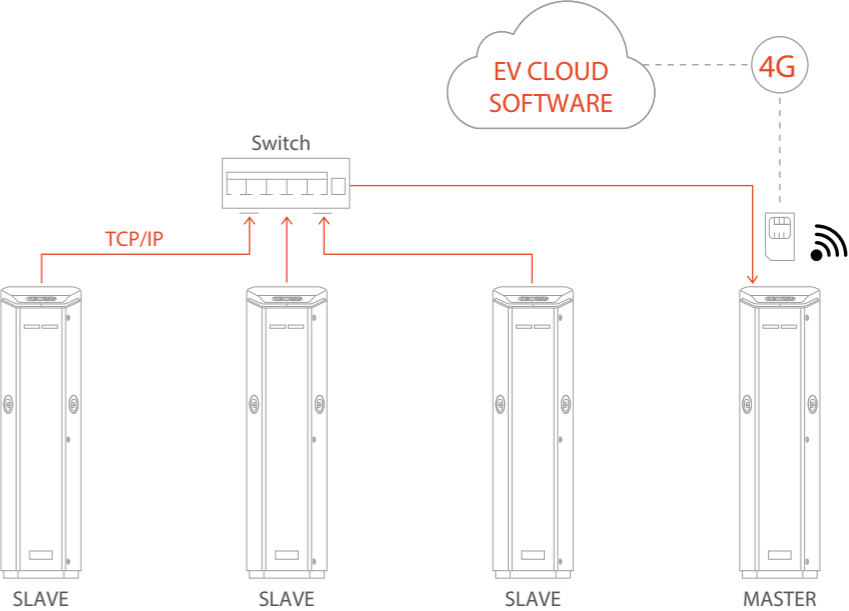

The charging stations are all equipped with Ethernet ports and can be wired to a switch in a star topology. Data is then transferred to the MASTER station that integrates a Router and the SIM. They are in and out wired with a TCP/IP line and only the last charging station has a 4G SIM that communicates with the backend via OCPP 1.6 JSON protocol.