

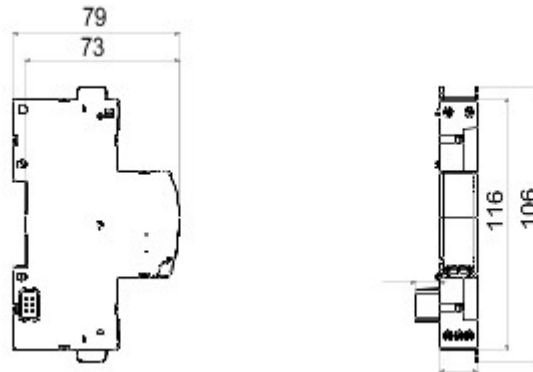

Wi-Fi communication interface module (GW90953) must be coupled on the right side of ReStart Autotest 2P and ReStart Autotest PRO 2P. Thanks to Wi-Fi ReStart APP, you can monitor the system status in real time and everywhere. The proper functioning of the residual current device can be tested at all times, operating self-diagnosis remotely with your APP: you have the possibility to have details about date, time and outcomes of all the Autotest operations. You can see the values of the energy produced and consumed, the active and reactive power, the current and the voltage of the system.

Omschrijving	Interfacemodule wifi	Code	90 ReStart range
Aantal modules EN 50022	1	Geschikt voor	ReStart Autotest PRO 2P
Nominale frequentie (Hz)	50	Nominale spanning	230/240 V a.c.
Max. vermogensverbruik	1,6 W	Bedrijfstemperatuur	-25 +60 °C
Nominale stoot-houdspanning (Uimp)	4 kV	Nominaal aandraaimoment	0,4 Nm
Opslagtemperatuur	-40 +70 °C	Nominale isolatie-spanning (Ui)	500 V
Standaard	EN 61326-1; EN 301489-1; EN 301489-17	Distributiesysteem	TT - TN-S
Doorsnede aansluitklem	2,5 mm <sup>2</sup>	Minimum requirements of the operating system	Android 4.4 / iOS 9
Wi-Fi communication	2.4	Maximum Wi-Fi range	100m free space trasmission (towards router) - 80m free space trasmission (other directions)
Maximum measurable current	80 A	CT maximum cable section	25 Quadratmillimeter
Measure of electrical parameters	Ja		

### DIMENSIONAL



### TECHNICAL SYMBOLOGY



### STANDARDS/APPROVALS

