

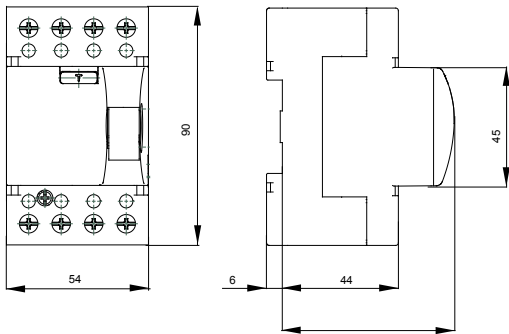

|   |                                  |
|---|----------------------------------|
| Description                               | RESIDUAL CURRENT CIRCUIT BREAKER |
| Code                                      | SD                               |
| No. of poles                              | 4P                               |
| No. modules                               | 3                                |
| Rated current                             | 40 A                             |
| Rated residual operating current          | 30 mA                            |
| Type                                      | A                                |
| Rated voltage (EN/IEC 61008-1, 61008-2-1) | 400/415 V                        |

|                           |                                   |  |                                  |
|---------------------------|-----------------------------------|--|----------------------------------|
| Standard                  | IEC/EN 61008-1, IEC/EN 61008-2-1  | Rated frequency (Hz)                   | 50 Hz                            |
| Insulation voltage (Ui)   | 500 V                             | Rated impulse withstand voltage (Uimp) | 4 kV                             |
| Overvoltage category      | III                               | Level of immunity (8/20 μs)            | 250 A                            |
| Section rigid cable       | <=1x35 - <=2x16 - <=1x16+2x10 mm² | Section flexible cable                 | <=1x25 - <=1x16+1x10 - <=3x6 mm² |
| Rated tightening torque   | 2 Nm                              | Double connection                      | YES (up stream and down stram)   |
| Operating temperature     | -25 +40 °C                        | Stocking temperature                   | -40°C + +70°C                    |
| Electrical endurance      | ≥ 5000                            | Mechanical endurance                   | ≥ 10.000                         |
| Auxiliaries compatibility | Yes                               | ReStart compatibility                  | No                               |
| Assembly position         | Any                               |  |                                  |

### DIMENSIONAL



### WIRING DIAGRAM

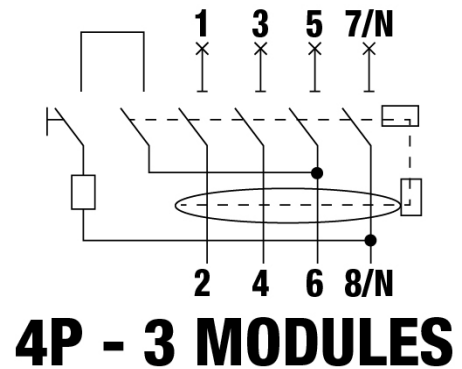

### STANDARDS/APPROVALS



GEWISS S.p.A. Via A. Volta, 1  
24069 Cenate Sotto - Bergamo - Italy  
tel. +39 035 94 61 11 fax +39 035 94 69 09  
Company subject to the management and  
coordination of Polifin S.p.A.

www.gewiss.com  
sat@gewiss.com  
Last update 12/06/2026

Data, measures, designs and pictures are shown  
only as informative purposes,  
and could be changed without previous notice