

# Product Data Sheet

## GW92089

90 MCB Range



Description MINIATURE CIRCUIT BREAKER

Code MT 60

No. of poles 4P

No. modules 4

Rated current 25 A

Curve C

Rated voltage 230-400 V

|   |   |   |   |
|---|---|---|---|
| Standard                                    | IEC EN 60898-1                                | Rated frequency (Hz)                        | 50/60 Hz                                      |
| Breaking capacity EN 60898 230V (Icn)       | 6000 A  | Breaking capacity EN 60898 400V (Icn)       | 6000 A  |
| Breaking capacity EN 60898 (Ics)            | 1 x Icn                                       | Breaking capacity IEC/EN 60947-2 230V (Icu) | 20 kA   |
| Breaking capacity IEC/EN 60947-2 400V (Icu) | 10 kA   | Breaking capacity IEC/EN 60947-2 (Ics)      | 75% Icu                                       |
| Insulation voltage (Ui)                     | 500 V   | Rated impulse withstand voltage (Uimp)      | 4 kV  |
| Minimum operating voltage                   | 12 V ac/dc                                    | Maximum operating voltage                   | 440 V AC / 220 V DC                           |
| Electrical endurance                        | 10.000  | Mechanical endurance                        | 20.000  |
| Section rigid cable                         | <=1x35 - <=2x16 - <=1x16+2x10 mm <sup>2</sup> | Section flexible cable                      | <=1x35 - <=2x16 - <=1x16+2x10 mm <sup>2</sup> |
| Rated tightening torque                     | 2 Nm  | Operating temperature                       | -25 +70 °C                                    |
| Stocking temperature                        | -40°C ÷ +70°C                                 | Electrocod                                  | 1411  |

### DIMENSIONAL

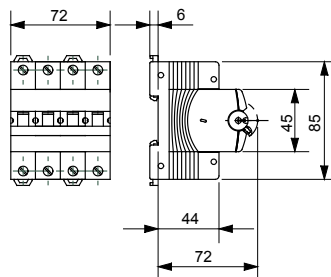

### STANDARDS/APPROVALS



GEWISS S.p.A. Via A. Volta, 1  
24069 Cenate Sotto - Bergamo - Italy  
tel. +39 035 94 61 11 fax +39 035 94 69 09  
Company subject to the management and  
coordination of Polifin S.p.A.

www.gewiss.com  
sat@gewiss.com  
Last update 19/06/2026

Data, measures, designs and pictures are shown  
only as informative purposes,  
and could be changed without previous notice