



A complete, versatile system of modular containers, perfectly integrable in the SYSTEM domestic range and able to meet the high protection installation requirements of the residential, commercial and industrial sectors. The 27 COMBI range is available both in the IP40 version and in watertight versions with IP55, IP65 and IP66 degree of protection, recommended for all outdoor applications which are subjected to extreme atmospheric conditions.

|                           |                          |                          |                           |
|---------------------------|--------------------------|--------------------------|---------------------------|
| Description               | With push-button         | No. gangs                | 2                         |
| Colour                    | Grey RAL 7035            | Type of knockout holes   | Removable with tool       |
| IP degree                 | IP66                     | Insulation class         | II                        |
| Lid screws                | Stainless steel          | Torque screws tightening | 0.8 NM                    |
| Outer dim. LxHxD (mm)     | 132x82x65                | Contacts                 | 1 NO-1 NC                 |
| Operators Ø 22            | Start (green) Stop (red) | Glow Wire Test           | 650 °C                    |
| Thermo-pressure with ball | 70 °C                    | Standard                 | EN 60947-1 - EN 60947-5-1 |
| Installation temperature  | -25 +60 °C               | Electrocod               | 0212                      |

#### BEHAVIOUR WITH CHEMICAL AND ATMOSPHERIC AGENTS

| Saline solution | Acids         |           | Bases        |           | Solvents           |               |               |                    | Mineral oil        | UV rays            |
|-----------------|---------------|-----------|--------------|-----------|--------------------|---------------|---------------|--------------------|--------------------|--------------------|
|                 | Concentrated  | Diluted   | Concentrated | Diluted   | Hexane             | Benzol        | Acetone       | Ethyl alcohol      |                    |                    |
| Resistant       | Not resistant | Resistant | Resistant    | Resistant | Limited resistance | Not resistant | Not resistant | Limited resistance | Limited resistance | Limited resistance |

#### DIMENSIONAL

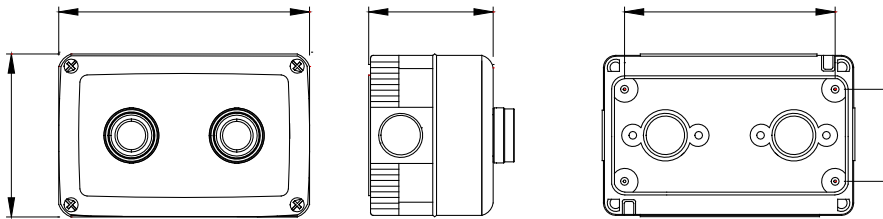

#### TECHNICAL SYMBOLOGY



**IP**  
IP66



II

**GWT**  
650 °C

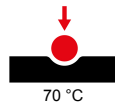

70 °C

#### STANDARDS/APPROVALS



GEWISS S.p.A. Via A. Volta, 1  
24069 Cenate Sotto - Bergamo - Italy  
tel. +39 035 94 61 11 fax +39 035 94 69 09  
Company subject to the management and coordination of Polfin S.p.A.

www.gewiss.com  
sat@gewiss.com  
Last update 04/07/2026

Data, measures, designs and pictures are shown only as informative purposes, and could be changed without previous notice